

# COTTAGE RAIN GARDEN

Site this lush little garden in areas that will capture water runoff for these water-loving species to absorb!



A rain garden is an inverted garden set in the landscape to absorb rainfall. They are sited in areas that are not already saturated with water, but key are locations to which water is intended to flow from upland areas or perhaps off a roof. This part sun/part shade garden will help alleviate erosion problems and surface water runoff through water absorption with plants that can also withstand dry spells. The cottage garden aesthetic provides plant diversity and seasonal visual interests.

## Section View

Comprised of a mix of grasses, ferns, flowers, and shrubs, this diverse haven will improve water quality and your conscious!





# COTTAGE RAIN GARDEN

## Planting Plan

*Carex lurida*  
Lurid Sedge (5)

*Anemone Canadensis*  
Wind Flower (4)

*Carex stricta*  
Tussock Sedge (5)

*Asclepias incarnata*  
Swamp Milkweed (5)

*Matteuccia struthiopteris*  
Ostrich Fern (3)

*Ratibida pinnata*  
Yello Coneflower (5)  
OR Sneezeweed

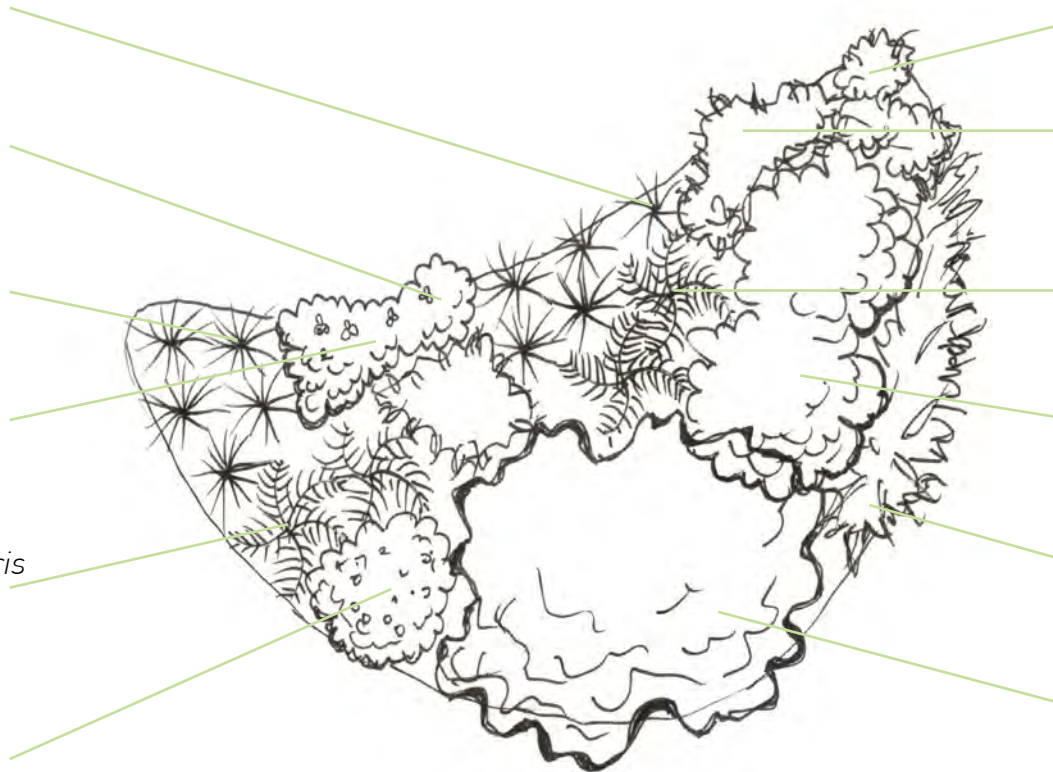

*Aquilegia Canadensis*  
Wild Columbine (3)

*Lobelia cardinalis*  
Cardinal Flower (4)

*Polystichum acrostichoides*  
Christmas Fern (3)

*Ribes americanum* \*  
Wild Black Curant (1)  
OR use a different currant

*Veronicastrum virginicum*  
Culbers Root (6)

*Cornus sericea*  
Red Osier Dogwood (1)

1" = 5'

\* Do no plant *Ribes americanum* near white pines