

South Spur of Black Dome

535-15

with Marc Wolf & David Turm 6/25/17 after
Mtn. Top Arboretum Board's tour of Bog #407.

WDS (A)

| site | p | Δp | Δe | calc | emap | time | R |
|--|---------|------------|-----|---------------|-----------------|-----------|--|
| (Z) Phoenicia | 30.74 | | | | | 9:00 AM ± | |
| (Y) Arboretum * | 29.23 | 0.26 | | | 2330' | 12:30 | $\frac{2330' - 2050'}{29.49' - 29.23'} = 0.26$ |
| (A) Colgate Lake pa. | 29.49 | begin hike | | $R_1 = 1.077$ | 2050' | 1:30 | |
| (B) E-W fence | 29.39 | 0.10 | 108 | 2158 | | 1:55 | |
| (C) water pipe at 2nd fence | 29.31 | 0.18 | 194 | 2244 | | — | |
| (D) leave flat & re-imb | 29.17?? | 0.32?? | — | — | | — | |
| (E) out of farm, UPL | 29.19 | 0.30 | 323 | 2373 | 2230 in 1968 | — | |
| (F) cross road E-W | 29.13 | 0.36 | 388 | 2438 | | 2:40 | |
| (G) cross 2nd road | 29.06 | 0.43 | 463 | 2513 | | — | |
| (H) head of pipe in spring | 29.04 | 0.45 | 485 | 2535 | | 2:53 | |
| (I) end 3rd road | 28.91 | 0.58 | 625 | 2675 | | — | |
| (J) steep bouldery slope | 28.78 | 0.71 | 765 | 2815 | | — | |
| (K) End hike in 2 ^o with stumps | 28.60 | 0.89 | 959 | 3009' | median 2945' | 4:05 | |
| (L) flat; fewer boulder | 28.96 | 0.86 | 831 | 2881' | | 4:25 | |
| (M) cross road, highest HEMLOCK | 29.10 | 0.50 | 483 | 2533 | | 4:53 | |
| (N) enter farm | 29.10 | 0.36 | 348 | 2398 | | 5:05 | |
| (O) fen, pine, cross fence at SNY blaze | 29.22 | 0.24 | 232 | 2282 | 2230 m 1968 | 5:20 | |
| (P) on Griffin Road | 29.43 | 0.03 | 29 | 2079 | | — | |
| (Q) on Griffin Road | — | — | — | — | 2080?? | ca. 6:00 | |
| (A) Colgate Lake pa. | 29.46 | 0.0 | | $R_2 = 0.966$ | 2050' | 6:30 | |
| (Y) Arboretum | 29.17 | 0.29 | | | 2330' | 6:45 ± | |
| (Z) Phoenicia | 30.67 | | | | | 7:20 PM ± | |

$$\frac{2330' - 2050'}{29.49' - 29.23'} = 0.26$$

$$\frac{2800' - 2050'}{0.26} = 1.077$$

$$\frac{2330' - 2050'}{29.46' - 29.17'} = 0.966$$

Vegetation History

535-16

(A) 2050' Leave parking area just below Colgate Lake dam & enter old fields with campsites. J. communis Native e. white pine stand on old fields plus SPRUCE-FIR-OAK-PB-NEM

(B) 2158' Cross high fence (steel grid, not barbed wire) running E-W, then begin to follow a water pipe upgrade. Because pipe is above ground, the building(s) it fed must have been summer-only. Another fence parallels pipe on E.

(C) 2244' Pipe crosses a 3rd fence running NW-SE, while pipe heads due N. few BRACKEN

(D) Flat terrace. Begin gentle reascent. PB-OAK-B-NEM-RM, becoming bouldery. Seep W of pipe with brook

(E) 2373' Out of old farm. B-OAK - few NEM. 30' ASH stumps ca. 50y.

(F) 2438' Cross 1st road heading up from SE to NW. 1 28" NEM. SUB common.

(G) 2513' 2nd road crosses pipe.

(H) 2535' Pipe ends at head of brook. 1 OAK, 1 NEM. Then 3rd road up to NW passing BASS & stump, turns NE between 2 lines of boulders pushed aside (snack stop)

Steeper above. Follow 3rd road up to NW through SUB - dam rich seep with BASS, OSMO, ALLIUM LAP, etc. until it ends.

(I) 2585' Stump collected on steep SUB slope. End 3rd road

(J) 2115' Older SUBs on steep, bouldery slope could be a small 1^o pocket. 1st low ledges. LAP seep. Top of steep pitch with 5 OAKs obs.

Climb 20' ledge through a chute. What is notch at 2050' tree seen through trees? Mink hollow?

(K) 3009' / 2881' Snack stop & end hike in OAK, ASH, OFT, SUB dom, MO, BCs more common above. Top 20' ledge. Loggers must have come in from the SIDE of the spur, not the steep nose we ascended. 3 stumps.

DESCENT

(L) 2533' Flat terrace at base of steep pitch. Fewer boulders

(LL) Cross road on level running E-W 4-5F.

(M) Cross 2nd road also E-W level. Stumps, rocky. 1st NEM locker above in seep. 2398'

(MM) Follow branch road until it joins another road running NW-SE.

(N) 2212/ Enter old farm.
FIR-SPRUCE-HEM PINE-PB-
BIOTIN-VACC. Cross
1st fence running E-W.

(O) 2079/ Run into an open
 fen below a HEM-dam-wide
Valley. Cross brook &
 head S along W side of
fen. Cross a 2nd
fence with a SMY blaze
 along it.

(P) Cross 2 channels of
 Halsey Brook. Wastes
 ahead.

(Q) Enter Griffin Road
 N of house #120 and
 pole #17204. An old 10' high
 sign post marks the spot.

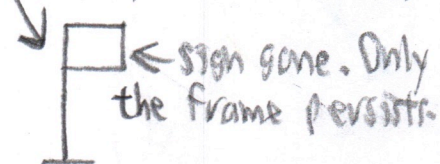

Drive up Griffin rd. next
 time to measure distance
 from (78) Colgate rd. Road.

SPRUCE & FIR, like PINE,
 are on old farm only.
 They drop out on always-
 forested slope above.
SPR & FIR + HEM are beneath
DM-PINE & PB + RM pioneers

Lot numbers.

535-17

Treat, McLean Othello Tract, Lots 12 (south)
 & 11 (north) purchased from Robt. B.
 SMY Acquisition: Colgate on 8/25/75. These lots straddle
74° 07' 30".

Colgate's North Line: If Colgates logged & sold
 Lots 12 & 11 to SMY in 1975, then maybe they logged up the
Black Dome South spur to their north line of Lot 11. Lot
 11 bands on State Land Tract Lot 76, acq. SMY in 1900#.
 Where does this boundary fall on the spur? Above it may be
 1°. Fraction of way from (78) Route to crest of B Dome-T. Cole:
 $\frac{38}{54} \text{ mm} = 0.70$ or $\frac{19}{27} = 0.70$. (O) Continued ↘

Farm abandonment:

1968 Kaatooskill Quad - shows (white) open
 fields to elev. 2230. Log roads & stumps are
 recent - prob mid 20th century, not Holdridge
 & West. Prior to 1975. Maybe 1960s or early 1970s.
 Did Colgate own this farm? Yes.

(O) Colgate's north line, continued -

Converted to miles on USGS 7.5 Quads: elev.
 $0 \text{ mm} = 0.0 \text{ mile} = \text{Route (78)} \rightarrow 0\% \quad | \quad 2050'$
 $100 \text{ mm} = 1.50 \text{ miles} = \text{Colgate N boundary} \rightarrow 70\% \quad | \quad 3240'$
 $143 \text{ mm} = 54 + 89 \text{ mm} = \text{B Dome-T Cole crest} \rightarrow 100\% \quad | \quad 3900'$
 Along 74°15' longitude line.

2.15 miles to crest.

$66.5 \text{ mm} = 1 \text{ mile at } 1:24000$

Lot 76 purchased in 1900
 (1920 List, page 25P).

Colgate N Line is 2.15 - 1.50 = 0.65 mile S of crest
 or at elev.

1° may be at 3240' if Colgate logged all the way
 to his N line and Holdridge & West did not go
 farther.

MAP

535-18

Colgate's N boundary is at elev 3240', 0.3 mile N of (K)

Road walk
 ± 3/8 mile on Griffin Road
 3/4 mile on (78)
 Σ 1 1/8 miles

Where we entered (A) Griffin Road to the (A) parking area by car is only 1/2 mile!

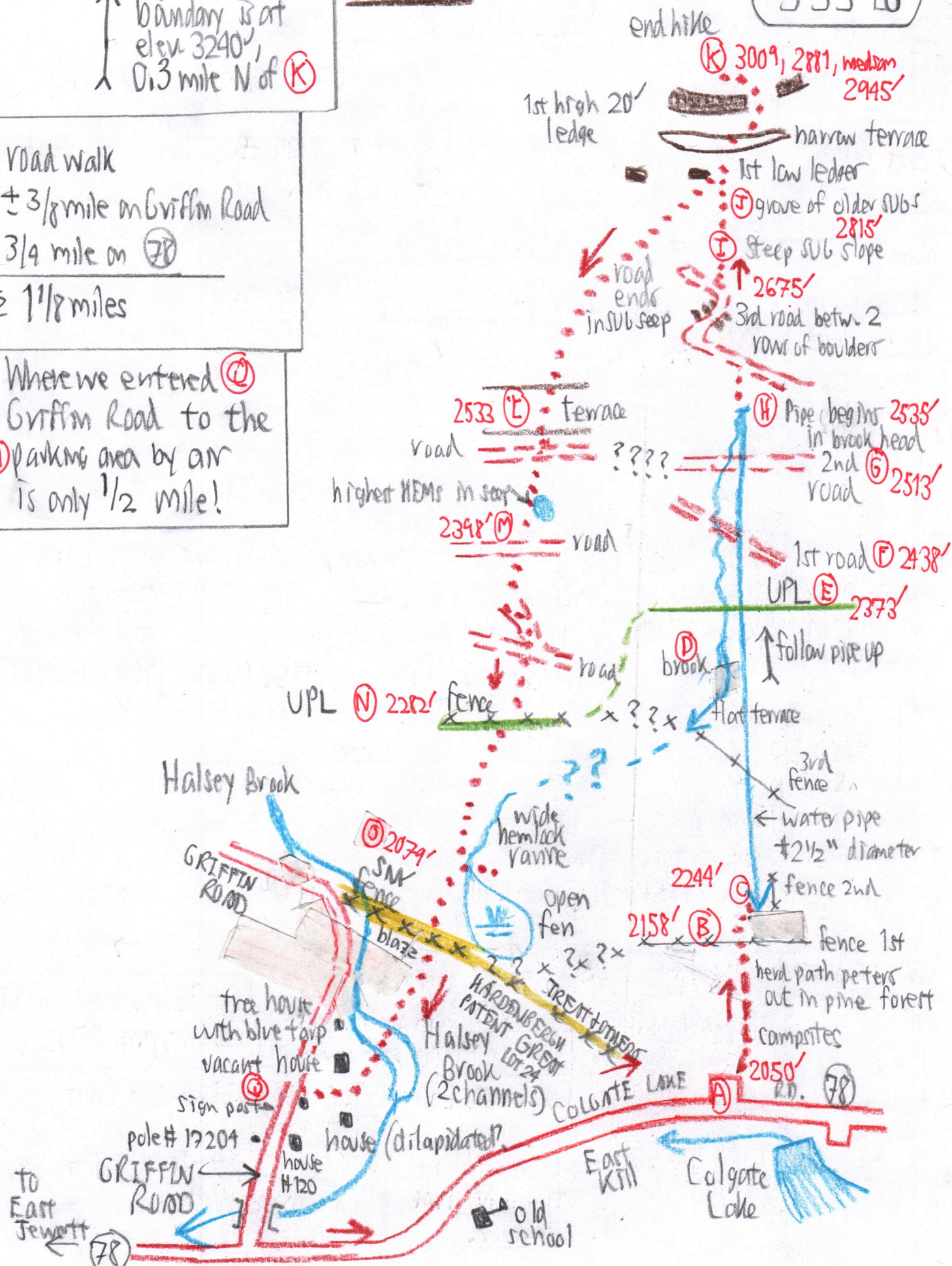

6/29/17

Extending the forest history of Black Dome's South Spur (pp. 535-15 to 18) eastward, integrating 6/9/85 notes (pp. 532-3 to 6) on Blackhead's south slopes.

- ① Figure out what lots were crossed in 1985. Treat & Others 887, State Land 63.
- ② Did Colgater own these lots? Yes, until 1963±, E side of blaze in 1985.
- ③ When did Colgater sell these lots? 1963± to Boys Club of NY
- ④ When were lots ⁶³ deeded high up on Blackhead? in the State Land Tract? 1980.
- ⑤ Is the north boundary of Treat, McLean & Others tract involved? No.
- ⑥ What is the yellow blaze from (C) to (E)? See below at *
- ⑦ Does e-p 1159 at 3100' correlate to the Treat tract boundary? (I) No.

The Treat & McLean Tract - State Land Tract boundary does not help locating the 20° → 1° boundary this far east because both sides of the former were privately owned until 1980.

Holdridge West could have logged the area N of Lake Cayuga in early 1900s. Then Colgater to 1963. Then Boys Club to 1980. Probably a combination of log roads at (D), (E) & (I) could date from a variety of periods before 1980.

* Blaze Line: The blaze line that MK followed on 6/9/85 cut through Treat & McLean Tract Lot # 887 at a low angle. ^{↑ between (C) and (E)}

To the east of this blaze, Colgater sold their land to Boys Club of NY ca. 1963. Then Boys Club sold to SNY 6/16/80.

To the west of this blaze, Colgater sold directly to SNY on 10/24/75.

∴ The blaze marked east boundary of SNY from 1975 to 1980. In 1980, both sides became SNY & the blaze was left to fade, but still visible in 1985.

The Boys Club → DEC sale in 1980 included State Land Tract Lot 63. Therefore, the Treat & McLean Tract - State Land Tract boundary is irrelevant here because Boys Club owned BOTH sides of it. Blackhead Summit is on Lot 63.

535-20

Stump age estimates in 1985:

- © 2371' - ±30 to 40y.
- Ⓔ 2866' - Ditto
- Ⓘ 3091' - Stumps still visible.

} This would date logging to
1940s or 1950s, then done by Colgates
who sold to Boys Club ca-1963.

Could have been logged by Umhay whose mill
was on Lake Capra on Folgate Estate (Lucks).