

204-19

5/7/77

Burr George Farm located by Douglas O'dell with his grandson & a friend

Vegetation:

- (A) Both Dicentras + Dent di in flower just above ford
- (B) widely-scatt. PB
- (C) apple tree
- (D) oak dem, some RM, Ash, BC, replaced by sapling SUB, B, CARP
- (E) VV and Allium both in rill

Notes:

(F) This is the un-named gully visited by Sally, James Co. on 11/11/16 (see pp. 204-8 & 9). Suggested name: WARREN TODD BROOK,

Gill Gully is 0.3 to 0.4 mile farther E, explored both sides by MK on 11/15/16 (see pp. 204-10 & 11).

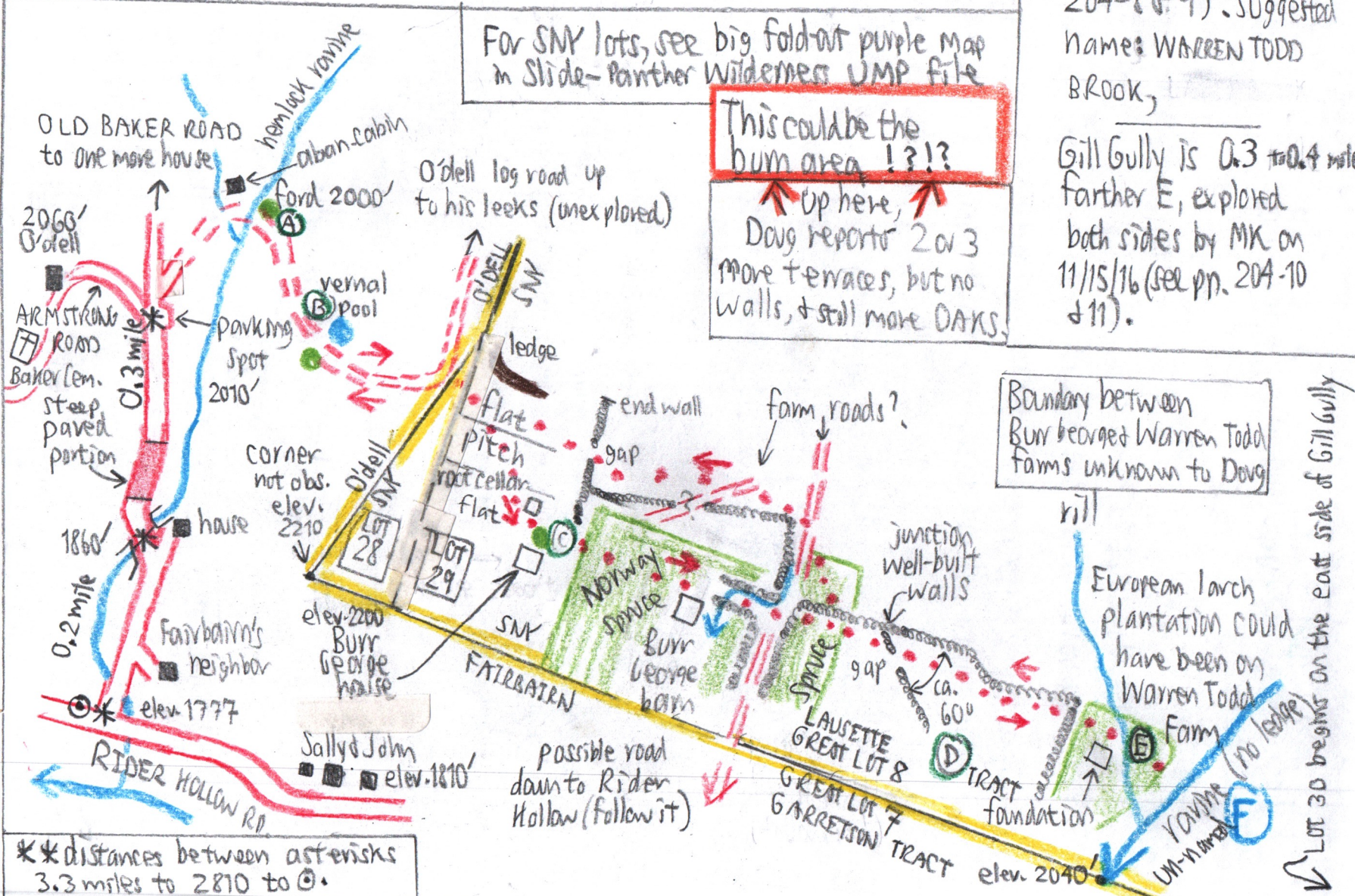

Hardenbergh Patent:

Burr George Farm is on Lot 29

Great Lot 8, Lavolette Tract

Town of Hardenbergh

Great Lot 7 follows SNR line just south of the farm bridge.

Lot 29 acquired in 1918.

Lot 28, SE wedge acquired in 1918 also

Road to Burr George Farm:

Follow it down from the barn. It should come out on Rider Hollow Road just west of the bridge over the unnamed brook, on Fairbairn lands. The 11/11/16 hike with Sally, James & Co. went only as far as the house, not the barn.

Forest fire site:

Must have been a woodlot and not an open pasture. Try exploring for charcoal above the house & barn sites. But if so high up, how could automobiles reach the burn unless they could get only as far as the barn?

Note that a Norway spruce plantation exists at the head of the unnamed ravine at elev. \pm 2400 to 2602 feet. Pastures had climbed this high but maybe on the adjacent Warren Todd Farm? See field notes pp. 202-33 to 36 for this spruce plantation (of 5/14/97).

Backwoods Club - Does anyone know their boundaries when sold to the State in 1918? South side of Rider Hollow?