

Acid Wood Roads in German Reservoir Hollows

For Middletown Hist-Soc. field trip

Mike Kudish

7/19/08

See photo P 295-5 / 290-105

- public roads ==
- hiking trail —
- abandoned roads - - -
- blaze lines

ASH, OAK, BLACK BIRCH, STURGEON ASPEN, PAPER BIRCH history: discuss.

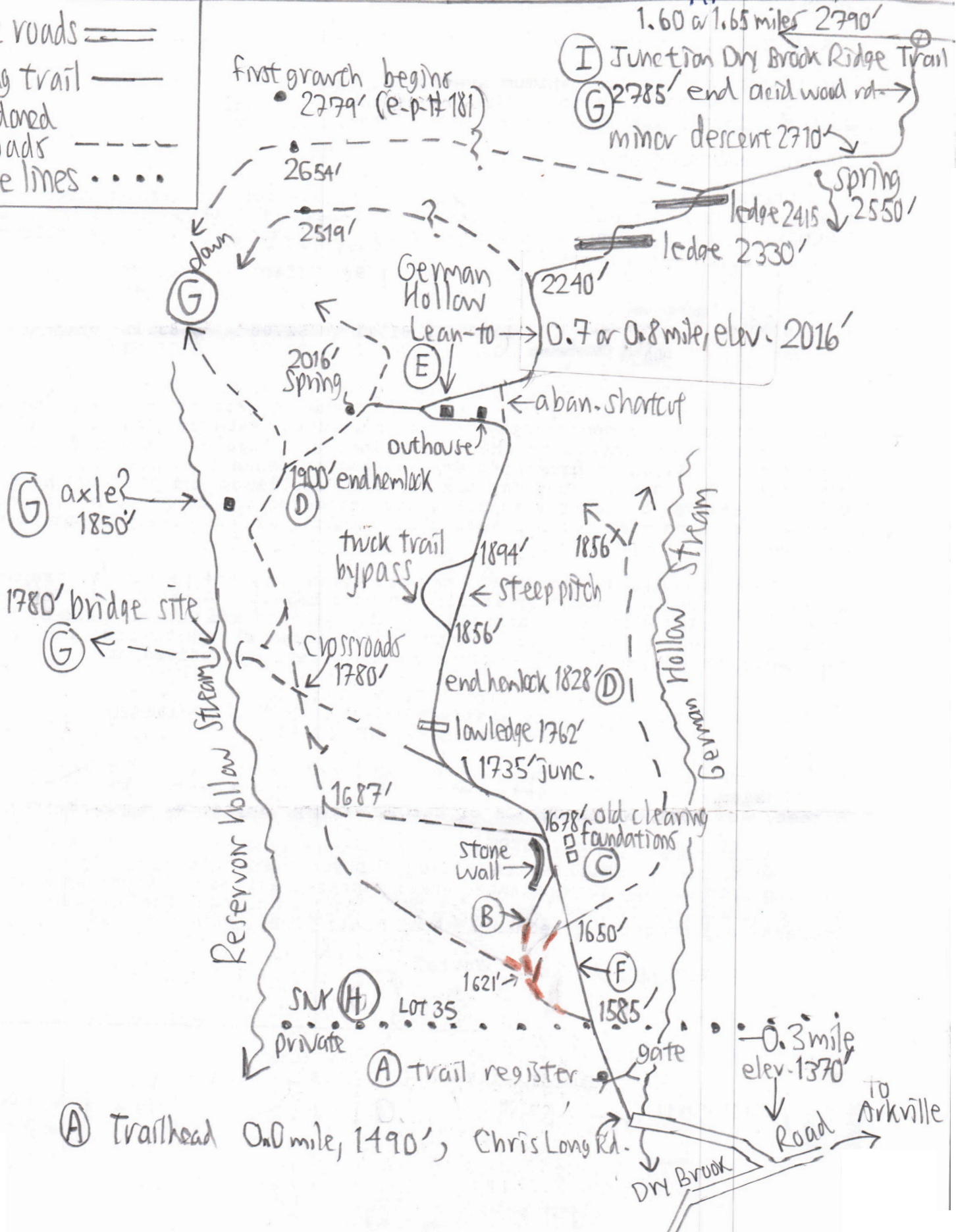

Historical Notes

290-106

- (A) German Hollow trail present, but not DEC-marked or maintained in 1951 (DEC map), but already present by 1967 map. In 1945 (Fleischmann Quadrangle), trail is shown, but head is at Erpf Estate where Dry Brook Road crosses over Reservoir Hollow.
Area around trail register logged for hemlock ca. 1995.
- (B) Original road to J-H-Dean's residence. Two acid wood roads (ca. 1900) diverge from it. See (G).
- (F) Road built later than (B), probably by CCC in 1930s for a ski trail (Adams et al. 1975, p. 60).
- (C) J-H-Dean residence. Not yet shown on 1856 Jay Gould map, but present on Beers' 1869 Atlas. Present on 1901 Margaretville Quad. With less than 1 acre cleared, not much of a farm - mainly a residence. Abandoned in early 20th century.
- (D) (2 sites). End of hemlock population. Two tanneries in Margaretville, but unknown if either barked here:
T6. James Chamberlain built 1863. Running 1880 by Jacob Baker. Located on Binnecill above Bridge Street.
T7. S. Chamberlain's running on 1856 & 1869 maps. Near present school.
- (E) German Hollow lean-to built 1962. Probably SMR marked & maintained German Hollow trail at same time.
- (G) Treyz' acid wood roads built just before or in 1900 (Annual Report, SMR Forest Commission, for 1900 photo, published 1901). Lucerne Chemical bought Treyz plant in Arkville in 1904 and ran it until ca. 1916 (Myers, p. 30?).
- (H) Lots → 35, 39, & 40 purchased by SMR in 1931. Lot 34, further south, betw. 1957 & 1970.
- (I) Dry Brook Ridge Trail built by SMR, 1936.