

FLORA OF THE MOUNTAIN TOP HISTORICAL SOCIETY'S 516-1

HAINES FALLS DEPOT "CAMPUS" — MICHAEL KUDISH ^{Bydelsaffe}
 MAY 21, 2004 (MK missed CCOD annual meeting at Woodstock)

Geographic regions:

- (A) Depot south boundary
- (B) Depot north boundary
- (C) barn + corral
- (D) Corral to east trail
- (I) Cemetery
- (E) Springhouse area — Osborne Rd.
- (F) Corral to north trail
- (G) brook at C+T R.R. grade
- (H) pond
- (J) Swamp east of pond

* planted and/or naturalized (not native)

TREES sp. Distn. Map in The C. Forest

- E. hemlock (A)
- E. white pine (E)
- Red spruce (A) p45
- Balsam fir (B) p22

- Yellow birch (A)
- Paper birch (A) (C) p25
- Gray birch (H)
- American hophornbeam (A)
- Beech (B)
- N. red oak (A) p40

- Bebb's willow (C)
- Bebb's X pussy willow (H)
- Bigtooth aspen (A)
- Trembling aspen (A) (E)
- White ash (A)
- Sugar maple (D) (F)
- Red maple (A)
- Striped maple (B)
- Mountain maple (A)
- Serviceberry (B) (E)
- Black cherry (A)
- Red cherry (C)
- Apple * (E)

Total spp.: 76

SHRUBS + LIANAS Vascular (A)

- Poisonivy (A)
- Meadow sweet (A)
- Choke cherry (A)
- Narrowleaf blueberry (B)
- Wild raisin (E) A28
- Winterberry holly (H)
- Currant (*R. cynosbati*) (G)
- Tartarian honeysuckle * (G)
- Red elderberry (F) (H)
- European lily * (A)
- Hawthorn (E)

- Karraw *? (F)
- Yellow rocket (F) *
- Dandelion * (A)
- Gill over the ground * (A)
- Burdock * (A)
- Garlic mustard * (A)
- Bedstraw * (A)
- Crown Vetch * (not *Vicia*) (A)
- Raspberry (A)
- Starflower (C)
- Yellow water lily (H)
- Blueets *? (H)

DICOT HERBS

- Strawberry (A) (C)
- Jewelweed (B)
- Large-leaf goldenrod ?? (B)
- Rough-leaf " (*nigosa*) (B)
- Wild sarsaparilla (C)
- Common cinerfoil *? (C)
- Forget-me-not * (D)
- (D) White woodland aster (*divaric.*)
- (D) Sharp-leaved aster (*aeumn.*)
- (D) Wood sorrel
- (D) Rattle snake root
- Golden alexanders (E)
- Red clover * (E)
- Tall meadow buttercup * (E)
- Northern buttercup ? (E)
- Anemone (E) wood
- Tall meadow rue (G)

MONOCOTS

- Sweet vernal grass * (A)
- (I) Canada mayflower (B) (D)
- Fringed sedge (E)
- False hellebore (G)
- Rush (to be I.D.) (E)

MOSSES: Common haircap (B)

FERNS

- Sensitive (A)
- Hay-scented (B)
- Lady (C)
- New York (C)
- Interrupted (C)
- Bracken (D)
- Wood (C)

5162

Richard Everett
SOC. Name
(518) 589-7579

Richard (Dick) Everett
Haines (518) 589-7579
gave MK a tour of the
tract 5/21/04.

The Swamp needs
exploring = E of pond

Confirm RR
ROW by
hiking
Osborne
Rd. in
June

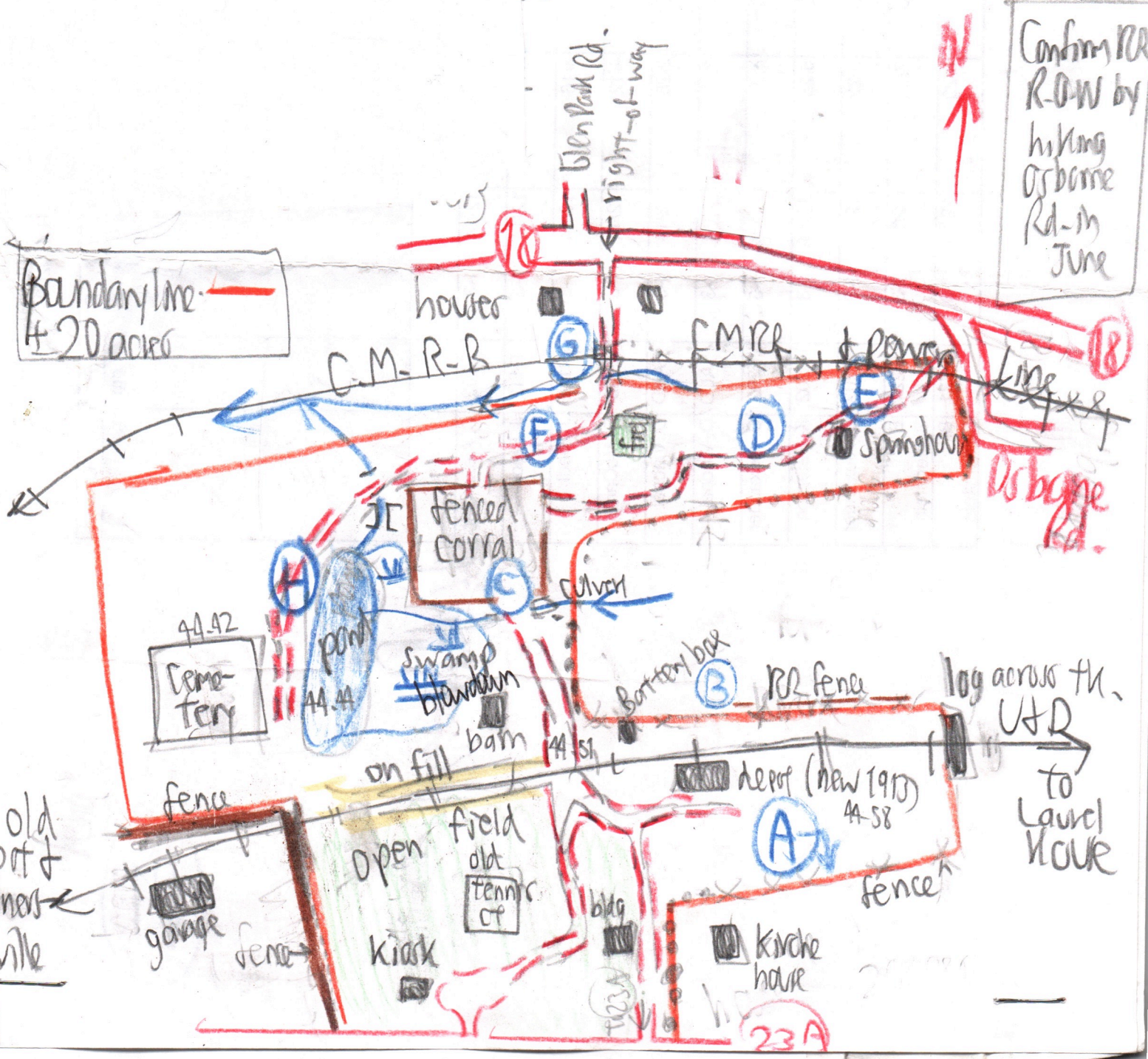

Boundary line
4 20 acres

old
2 part
mes
vile

44.42
Cem-
tery

44.44
pond

fenced
corral

swamp
blowdown
barn

open
field
old
tennis
ct
kiosk

battery
box

RR fence

depot (new 1913)
44-58

log across the
UTR
to Laurel
HOUER

A

23A

18

18

Osborne
Rd.

Glen Park Rd.
right-of-way

houses

C.M.-R.-B

FMRR + power

Spinshouse

culvert

garage

kirche
house

123A