

Dry Brook Ridge Bogs -

(See field notes of 5/31/70)

5/7/94 290-30

Bog #	(Wet flat) location	Dominant spp.	Present spp. Woody	Herbs	Peat details
3	col between N & middle summits Elev. Trail crosses it	YB-RM	B-MO [BC nearby, S, & 10' higher has pancake 18 to 24" deep to ledge]	Clay & Ery in fl. VV OX-LL S montana nil Sphag.	wettest area the trail crosses - a tiny brook flowing SW & then disappearing SAMPLE W of trail: 8" of O.M. on till. Sample taken at base of O.M. SAMPLE E of trail: 6" of O.M. to channer Many attempts only 2" to 4" deep to channers or dense till Sample taken at base of O.M. at deepest pit.
4	on terrace on N slope of middle summit Elev. 303 W of trail	YB-RM thicket of VCAS-NEMO between trail & pond	B, BC, MO surrounding	Ery, LL Coptis CINN (or O. clayton?) VV Cx follic. much Sphag.	SAMPLE SW end of open pool Max 6" to channer. All other pits 2" to 5" to channer. SAMPLE NE end of pool, along deer trail into NEMO-VCAS thicket. 9" to channer max. SAMPLE between ^{hiking} trail & NEMO-VCAS thicket. Max 9" to grey till of many pits.
5	N end of col between Middle & Sarah summits; N of SW look out - NE of trail	YB	MO B RM BC	VV LL Ery CINN? narrower-ld. Carex Claytonia nil Sphag.	SAMPLE: max 9" between 2 channers. Most pits << 9".
6	S slope of Sarah Peak.	[Noted in 1970; <u>NOT</u> relocated in 1994]			
7	About 40' below & N of the 3040' Knob; E of trail 304	YB	BC-B-MO	nil Sphag. ERY-VV- OX-	SAMPLE 14" to Channer.

Location **290-37**

Timetable 5/7/94

Location	Northband	Southband
A Mill Brook Road	1:00 ↓	5:55 ↑
B Hill 3040'	1:20	5:38
C Wet Flat #7, ca. 2980'		5:35
D *Lean-to, ca 2700'	1:35	5:15
E 4 cameras in col, 2860'	1:38	5:12
F ASH		5:10
G OAK	1:50	5:07
H herb spp. change		5:05
I Pedestal ledge		5:03
J VV flat on W		5:02
K big Allium patch on E		5:01
L South Summit	2:15	4:44
M Snack ledge		4:17 → 4:33
N Wet Flat #5	2:35	4:05 → 4:11
O Middle Summit	2:43	3:55
P Red trail to W (follow 1/8 mile)		3:50
Q #4 Wet Flat	2:17	3:20 → 3:15
R #3 Wet Flat	2:53 →	3:15

* DEC Sign says 1.2 or 1.5 mi from Mill Brook Rd, 6.40 mi to German Hollow lean to 8.15 mi to Margaretville (Trail head)

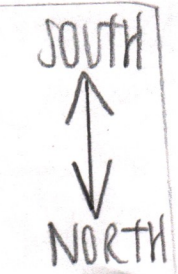
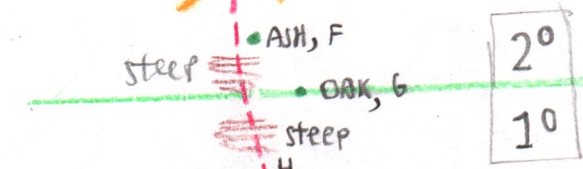
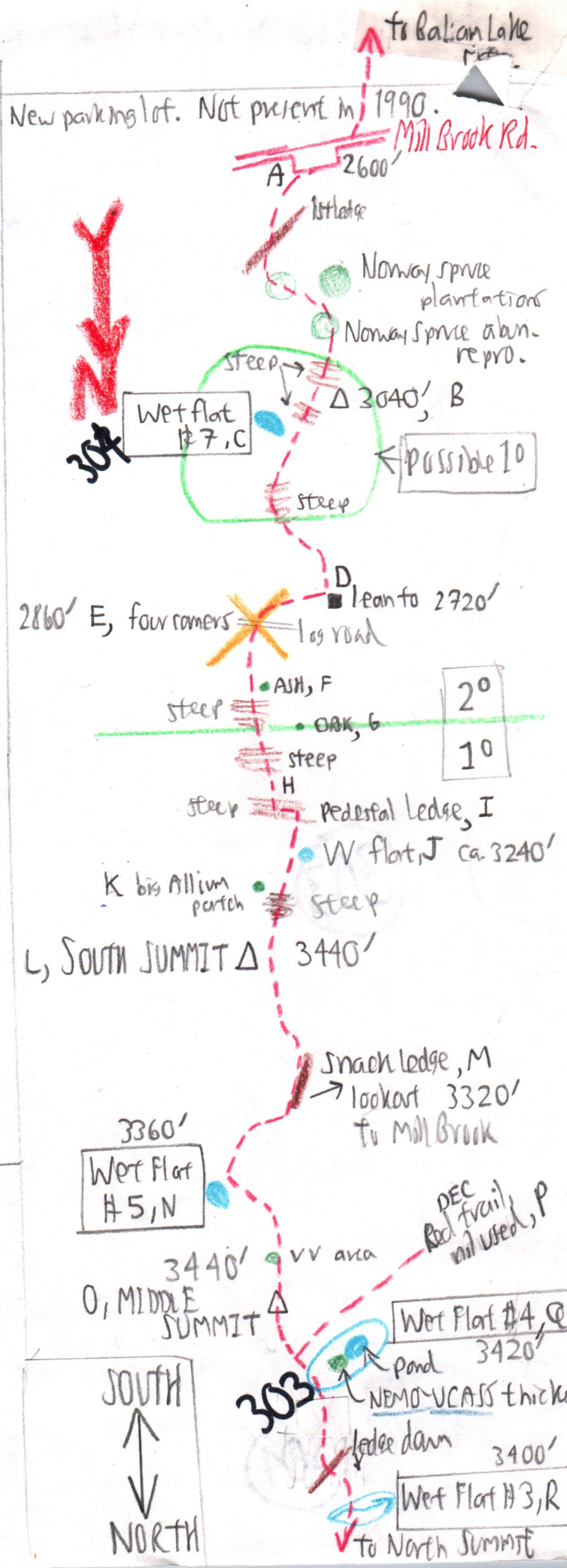

Mileage:

Valkyrie 65, 539.65
 Trail Head, 65, 552.9
 Mill Brook Rd.
 25-minute ride,
 13.35 mi.

A Wildflowers in bloom
 at trail head:
 TE, VC, Vrot,
 Vblanda, Clay, ERX,
 Dic cuc, ASH

G. MIDDLE SUMMIT:

Canon to 30', less stunted
 contorted than at South Summit.
 VB-BC-B-RM-RG

2 Norway spruce reprod. areas,
 many trees each, mostly 10 to 20' tall.

Lean-to: CB in fl. bud under SUB-VB-BC
 OX
 ASH to 2 minutes above
 4 corners (but no
 ASH on upper slopes +
 summit of 3040' knob.

No Balsam fir observed anywhere.

G. OAK, 8 minutes up (5 down) from 4
 corners, off trail on W ca 100 ft.
 Detected by leaf litter on trail.
 One tree, ca. 18" DBH.
 Prob. 1st growth above.

I. Pedestal Ledge area (2 pedestals
 E of trail midway up a ± 60'
 ledge. Major change in ground
 cover here:

DIC CAN in fl bud	} all Upper limit at ledge base.
DIC CUC in fl.	
HYDRO	
CAULO	

PA
 Base of ledge on E: SUB pancake in 20" →

K. Big Allium patch, highest possible,
 and not always on a wet site.
 Just above this, below the last
 steep pitch, SUB dominates
 and DICENTRA, highest, OCCURS.

a slightly wet
 CAULO-ALLIUM-OST-HYDRO
 area, not truly a spring.

L, SOUTH SUMMIT; E of trail about 30' higher
 Trees stunted & twisted, 20 to 25'
 (maybe 30' max) tall, B-BC dom
 with some KB, MODRM. Most
 stunted on W below trail, Beech.
 1st LL.

M- Snack ledge: MITCH. Big SUBs below, a few above on crest and smaller

DBR #3, West

290-32A

DBR, N end

5/13/94

Trailside flora: no bog info.:

Mostly amorphous A.M.
 Many white quartz sand grains & granitic
 A few KB bark fragments
 Many roots, live.
 Beech(?) leaf fragments

DBR #4, NE of Pond

Woody tissue, possibly from roots,
 2 to 3 mm diameter

Carex achene?
 Roots with nodules 0.5 mm long

#303

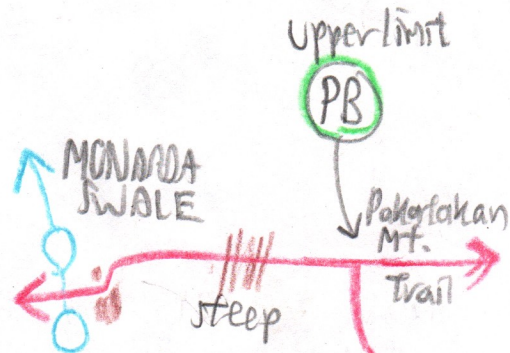

Mitella, V rot, V pap
 Anemone quin. in fl.

Uvul. clone, large
 dead PB, ASM, ORN, SUB
 ledge

ledge with till; trail
 eroded to 18" to 24"
 to 48" under ORN-SUB-B

gullied & steep

fossil branching plant
 in ledge on trail

Geman Hollow
 lean-to

shortcut much overgrown
 out house

Upper limit NEM

homestead
 farm site

old road

old road

registration
 booth

CHRIS LONG RD., no longer SUPERLINO RD.

Trail Head	8:50 AM	3:55 PM
Pakarakan Jc.	10:40	2:55
Wet Flat #2 (open pool bog)	11:35	1:15 PM

Flora at lean-to area - moist terrac
 2 spp Dicentra SUB-ASM dom
 VC, Vpub, Vpap
 TE, TU
 Tigrella
 Smilacina in bud
 Clayt