

Fenwick RR via Myrtle Brook to Devil's Acre 343-1

with Ricky & Tommy Brooks, Bruce Hurlburt (PSC '87) 10/6/90 (see p 340-116)

Site	P	Δp	Δe	e	Map e	Time	rates
A) Route 214 Benchmark elev 1623'	30-32	0	0	1623	1623'		
B) Lanesville Dump	30-20	0-12	107	1730			$\frac{30.32'' - 28.16''}{3540' - 1623'}$
C) Begin hike	30-05	0-27	240	1863		9:20 AM	
D) S boundary mill yd.	30-00	0-32	284	1907			$= \frac{2.160''}{1917'} = 0.8875$
E) Mill	29-94	0-38	337	1960			
F) Beech Smith's logging	29-78	0-54	479	2102			
G) 1st ledge	29-71	0-61	541	2164			
H) 1st ledge	29-57	0-75	666	2289			
I) 1st ledge	29-46	0-86	763	2386			
J) 1st ledge	29-36	0-96	852	2475		10:48 (J)	
K) 1st ledge	29-26	1-06	941	2564			
L) Storewax photo	29-06	1-26	1118	2741			
M) Cut	28-86	1-46	1296	2919			
N) 1st mature SPR	28-72	1-60	1420	3043			
O) Junc. lunch	28-66	1-66	1473	3096		12:07 PM	
P) 1st FIR	28-48	1-84	1633	3256			
Q) 1st FIR	28-38	1-94	1722	3345			
R) Devil's Acre	28-21	2-11	1873	3496	3500	12:33 → 1:04	
S) Col	28-16	2-16	1917	3540	3540		
		1-28	1220	3540			
T) Wheel	28-36	1-08	1029	3349		2:16	$\frac{29.44'' - 28.16''}{3540' - 2320'}$
U) SUB center	28-56	0-88	839	3159			
V) Camp	28-68	0-76	724	3044		2:50	$= \frac{1.28''}{1220'} = 0.953$
W) Landslide	28-65	0-79	753	3073			
X) on trail	28-65	0-79	753	3073		3:40 (X)	
Y) ASH	29-13	0-31	295	2615			
Z) Avalon vac.	29-30	0-14	133	2443			
AA) Red Horse Falls	29-44	0	0	2320	2320'		
BB) Kanan	29-64	0-26	237	2320			$\frac{29.70'' - 29.44''}{2320' - 2083'} = 0.26''$
CC) Jones Gap Rd Jc.	29-70	0	0	2083	2083'	4:40 PM	$= \frac{0.912''}{237'} = 0.912$

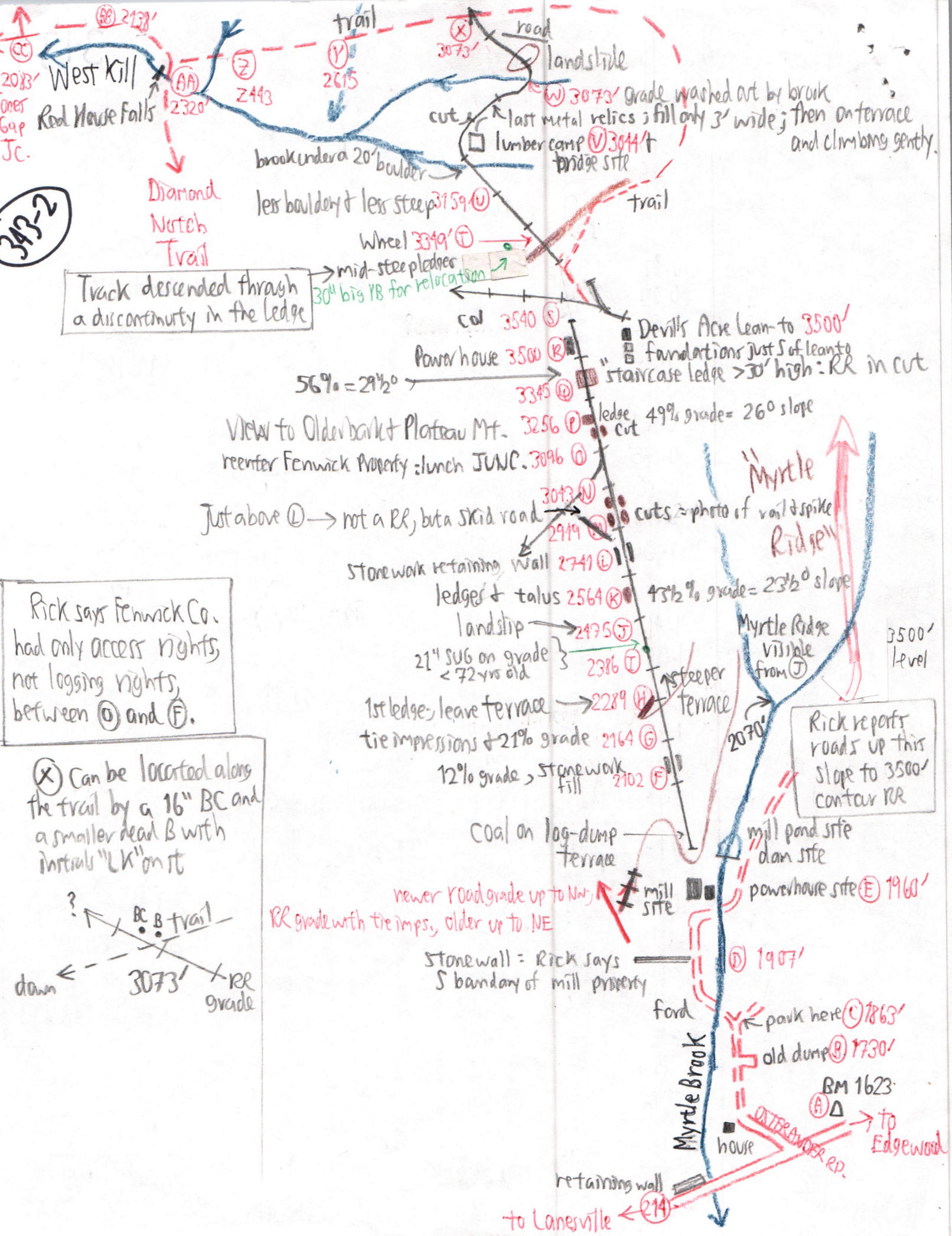

343-2

2083' over Gap JC.

West Kill
Red Horse Falls
Diamond Notch Trail

Track descended through a discontinuity in the ledge

$56\% = 29\frac{1}{2}^\circ$

View to Oldenbark & Plateau Mt.
reenter Fenwick Property: lunch JUNC.

Just above (D) → not a RR, but a skid road

stone wall retaining ledge & talus
landslide
21" sub on grade < 72 yrs old

1st ledge, leave terrace
tie impressions & 21% grade
12% grade, stone wall fill

Coal on log-dump terrace

newer road grade up to NW, RR grade with tie imps., older up to NE

Stone wall = Rick says S boundary of mill property

Myrtle Brook

Myrtle Ridge

Myrtle Ridge visible from (J)

Rick reports roads up this slope to 3500' contour RR

mill pond site
dam site

powerhouse site (E) 1960'

(D) 1907'

park here (C) 1863'

old dump (P) 1730'

BM 1623

house

retaining wall

to Lanerville ← (214)

3500' level

to Edgewood

Rick says Fenwick Co. had only access rights, not logging rights, between (D) and (F).

(X) Can be located along the trail by a 16" BC and a smaller dead B with initials "LK" on it

