

State Land Acquisition into Forest Preserve, Westkill Mtn. Mike Kudish 11/23/89

← streams

Great Lot # in Hardenbergh Patent

Approx.



Not to scale

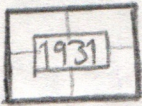

Lots with date acquired in box

..... Westkill Mt. trail (approx. location)



individual lots, average 150 acres.

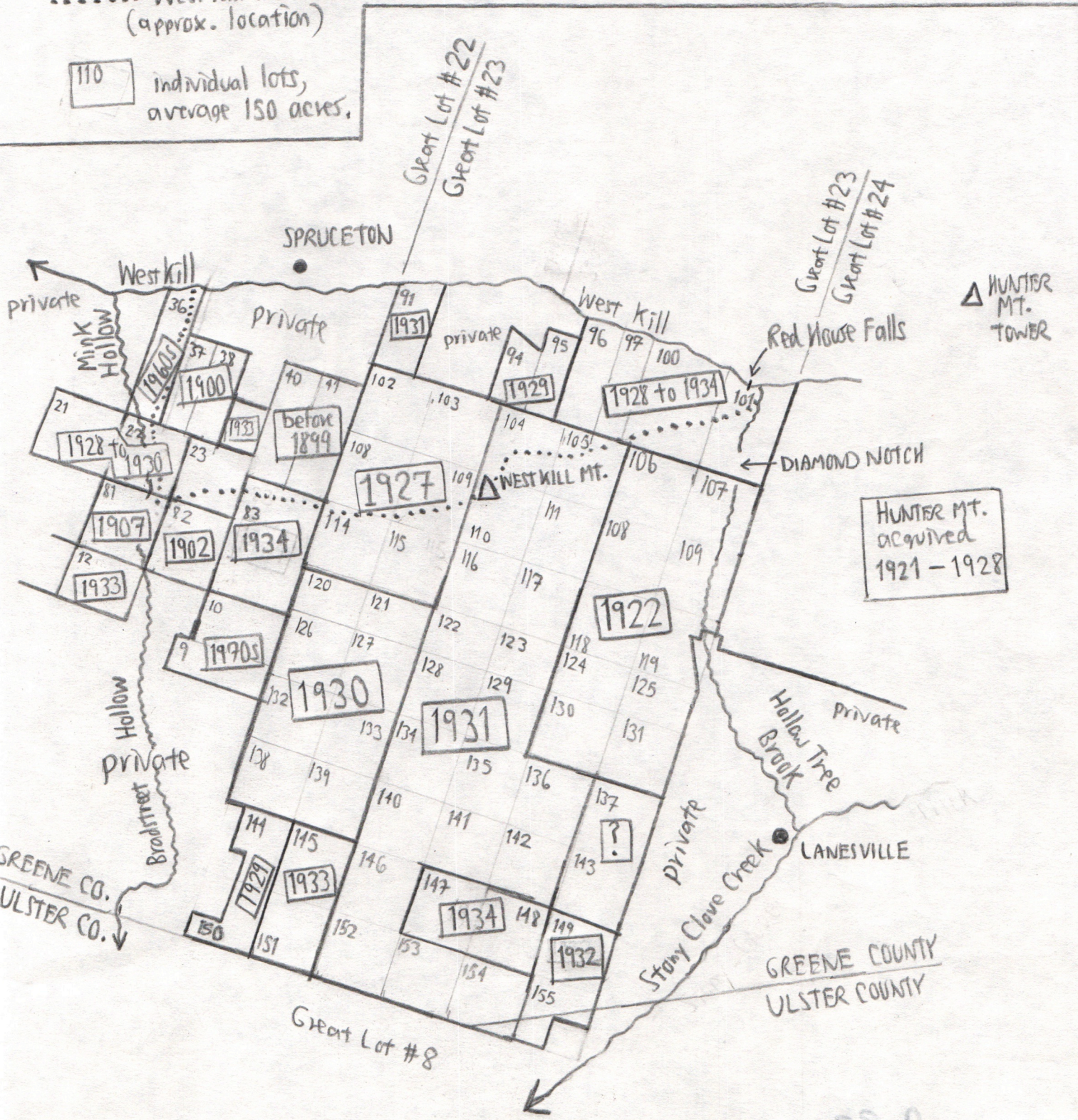

HUNTER MT. acquired 1921 - 1928

388P

SNY Lot Acquisition:

Great Lot 22

Great Lot 23

Great Lot 24

SNY 1899

Lots 23, 40, 41
only ✓

None 1899

None 1899

SNY, 1957:

37, 38, 39 S¹/₂,

40, 41

22, 23

81, 82, 83

12, W¹/₂ 7

SNY, 1957:

91, 94 S¹/₂, most of

95, 96, 97, 98, 99

100 → 155 with

following exceptions:

149, S¹/₄

150, 132 & 138 W³/₄

Hunter Mt.

N of lot 59

SNY 1970, but not
1957:

36 W¹/₂

SNY 1970, but
not 1957:

West of 132 & 138

SNY 1983, but not 1970 →

N¹/₃ of 9

10

36 W¹/₂

ditto

S¹/₄ of 149

87 & 88 S¹/₂

along west
Kill Creek

From 1920 State Land List

~~Great Lot 23: Lots 87 & 88, N ends, 1908. Lot 96, W¹/₂, 1908.~~

~~Great Lot 22: Lots 37 S¹/₂ & 38, 1900.~~

~~Lot 40: 1908~~

~~Lot 41: 1877 → 1898~~

~~Lot 81: 1907~~

~~Lot 82: 1902~~

} mainly around
Mink Hollow.

357

West Kill Mtn. Forest History : Mike Kudish 11/23/89

N
↑
Not to Scale

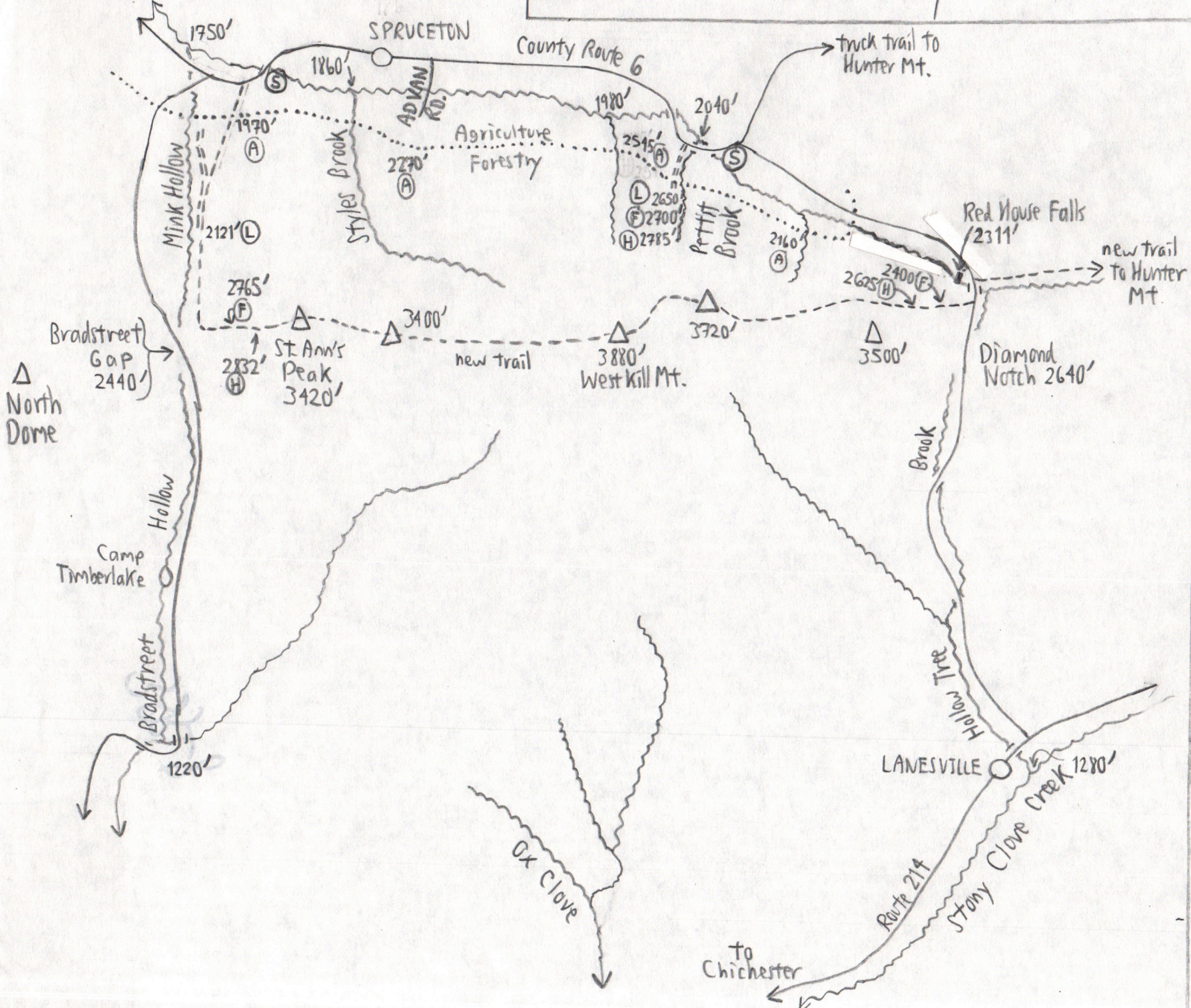

← Streams
— roads
- - - foot trails

Upper limits:
 - - - - agriculture.
 Max. elevs. in feet
 of old fields (A)
 - - - - log roads
 (L) with max. elev.
 (H) Hemlock max.
 elevs. in feet
 (F) of logging.
 1st growth above
 this elev. max.

(S) Sawmill in
1867

Elevations of
confluences,
cols & summits,
in feet.