

530-14

Scale: very roughly
2 inches per mile

State Lands in Red
Suggested Purchase in Green

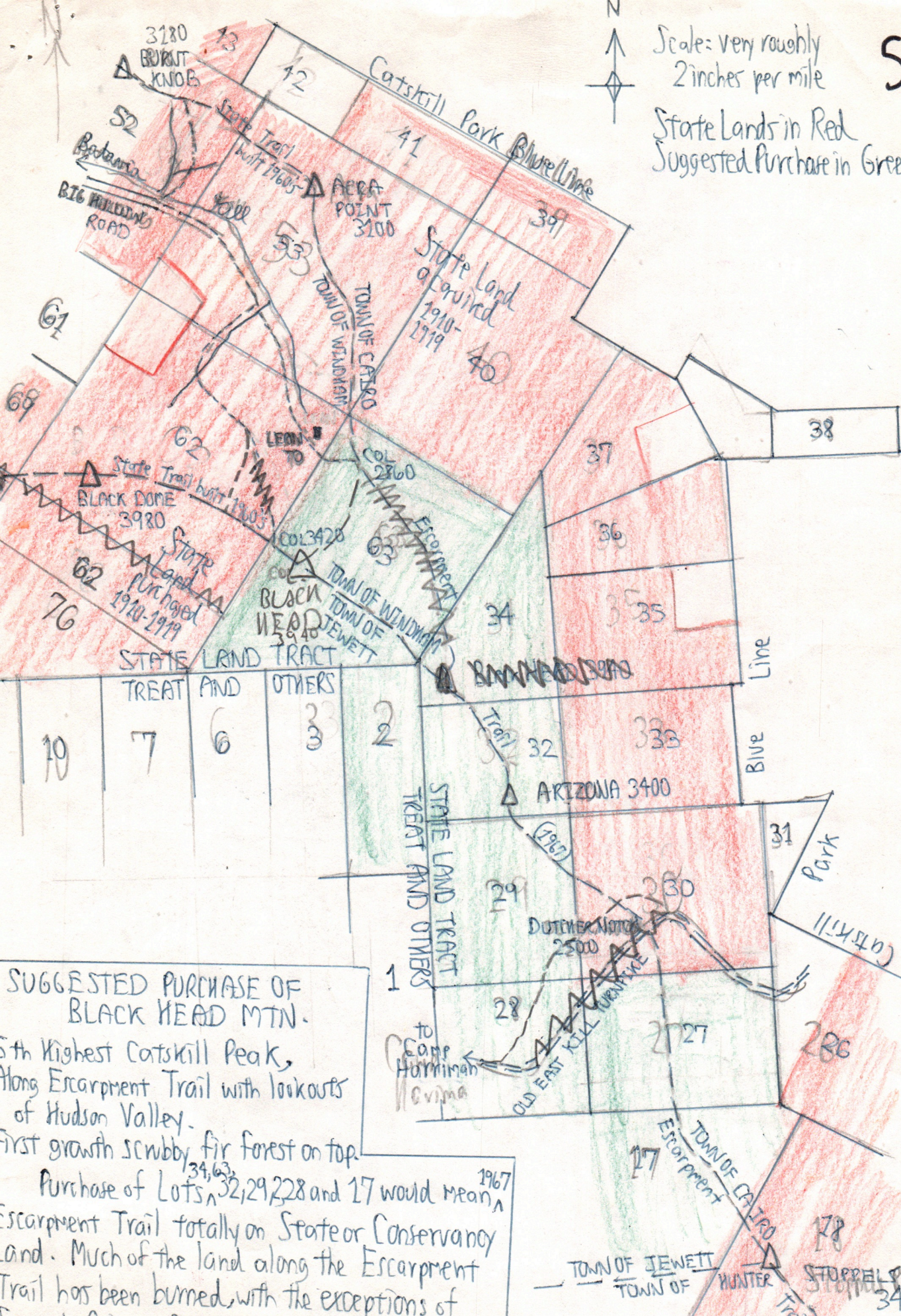

SUGGESTED PURCHASE OF
BLACK HEAD MTN.
5th Highest Catskill Peak,
Along Escarpment Trail with lookouts
of Hudson Valley.
First growth scrubby fir forest on top.
Purchase of Lots ^{34, 63} 32, 29, 228 and 17 would mean
Escarpment Trail totally on State or Conservancy
land. Much of the land along the Escarpment
Trail has been burned, with the exceptions of
Stoppel Point & Blackhead summits.

Mike Kudish
7129172

