

7255

E 400,000

7250

E 420,000

7245

E 440,000

7240

E 460,000

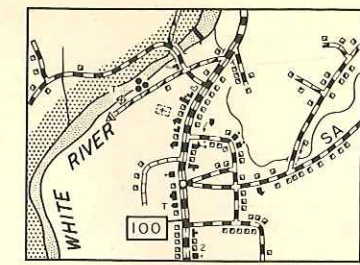

INSET ①  
ROCHESTER  
SCALE  
0 0.1 0.2 MILE

SAM Vinton's FARM  
BRAintree - ORANGE CO.  
Plots 1-10



N 520,000

43°55'

N 500,000

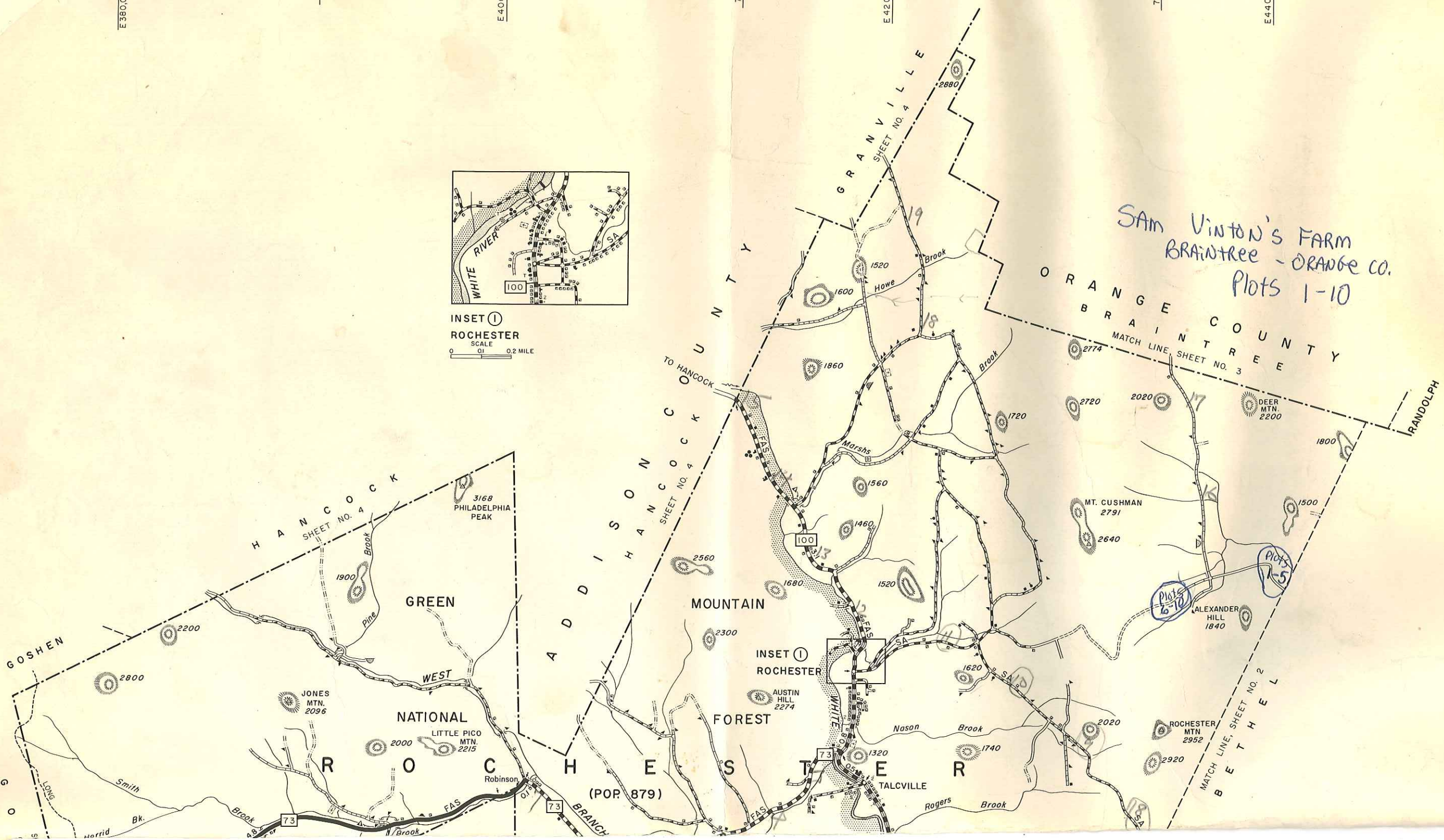



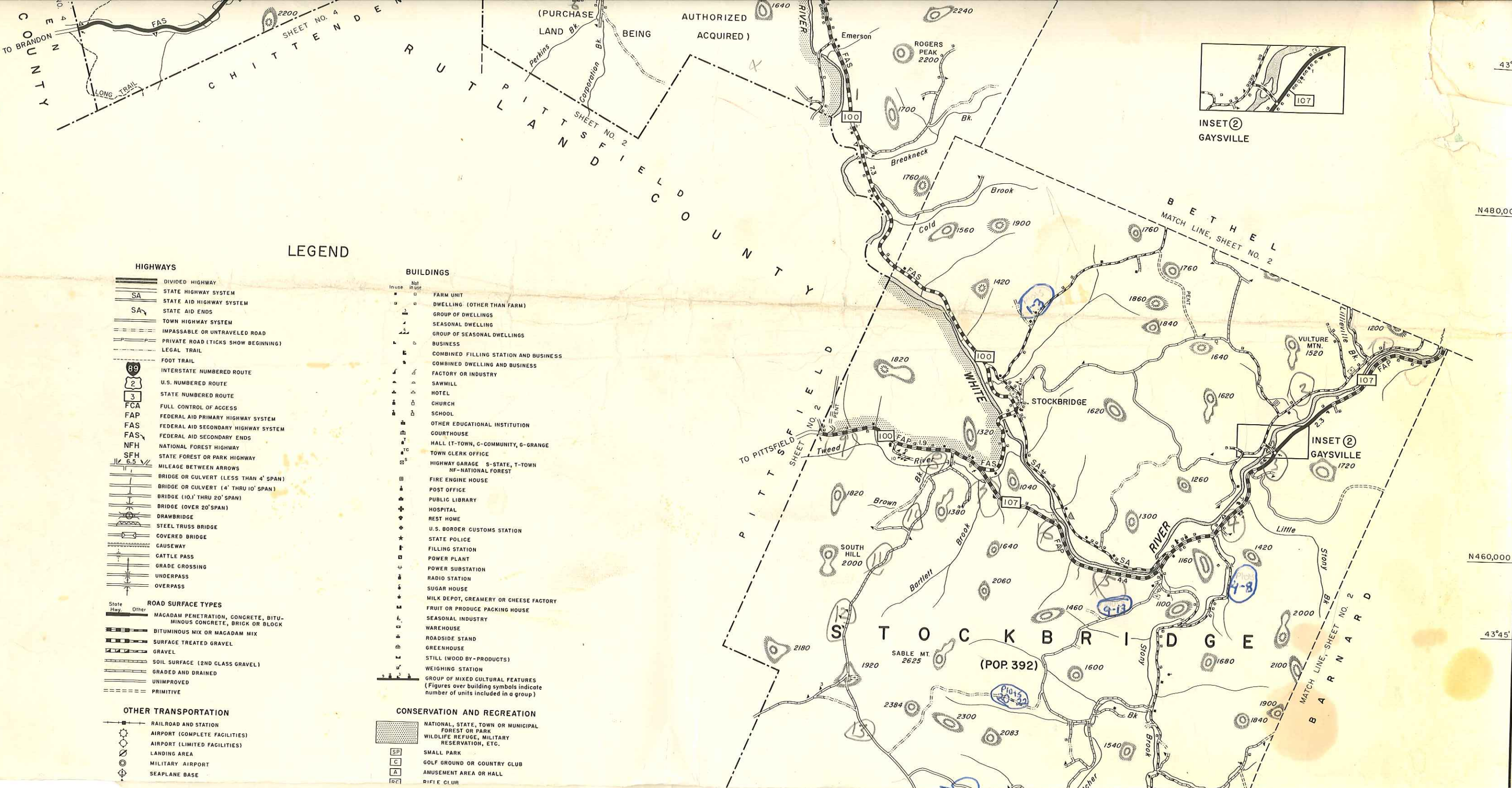

**LEGEND**

- HIGHWAYS**
- DIVIDED HIGHWAY
  - STATE HIGHWAY SYSTEM
  - STATE AID HIGHWAY SYSTEM
  - STATE AID ENDS
  - TOWN HIGHWAY SYSTEM
  - IMPASSABLE OR UNTRAVELED ROAD
  - PRIVATE ROAD (TICKS SHOW BEGINNING)
  - LEGAL TRAIL
  - FOOT TRAIL
  - 89 — INTERSTATE NUMBERED ROUTE
  - 2 — U.S. NUMBERED ROUTE
  - 3 — STATE NUMBERED ROUTE
  - FCA — FULL CONTROL OF ACCESS
  - FAP — FEDERAL AID PRIMARY HIGHWAY SYSTEM
  - FAS — FEDERAL AID SECONDARY HIGHWAY SYSTEM
  - FAS — FEDERAL AID SECONDARY ENDS
  - NFH — NATIONAL FOREST HIGHWAY
  - SFH — STATE FOREST OR PARK HIGHWAY
  - 6.5 — MILEAGE BETWEEN ARROWS
  - BRIDGE OR CULVERT (LESS THAN 4' SPAN)
  - BRIDGE OR CULVERT (4' THRU 10' SPAN)
  - BRIDGE (10.1' THRU 20' SPAN)
  - BRIDGE (OVER 20' SPAN)
  - DRAWBRIDGE
  - STEEL TRUSS BRIDGE
  - COVERED BRIDGE
  - CAUSEWAY
  - GATTLER PASS
  - GRADE CROSSING
  - UNDERPASS
  - OVERPASS
- ROAD SURFACE TYPES**
- State Highway: — MACADAM PENETRATION, CONCRETE, BITUMINOUS CONCRETE, BRICK OR BLOCK
  - Other: — BITUMINOUS MIX OR MACADAM MIX
  - SURFACE TREATED GRAVEL
  - GRAVEL
  - SOIL SURFACE (2ND CLASS GRAVEL)
  - GRADED AND DRAINED
  - UNIMPROVED
  - PRIMITIVE
- OTHER TRANSPORTATION**
- RAILROAD AND STATION
  - AIRPORT (COMPLETE FACILITIES)
  - AIRPORT (LIMITED FACILITIES)
  - LANDING AREA
  - MILITARY AIRPORT
  - SEAPLANE BASE

- BUILDINGS**
- Not in use
  - FARM UNIT
  - DWELLING (OTHER THAN FARM)
  - GROUP OF DWELLINGS
  - SEASONAL DWELLING
  - GROUP OF SEASONAL DWELLINGS
  - BUSINESS
  - COMBINED FILLING STATION AND BUSINESS
  - COMBINED DWELLING AND BUSINESS
  - FACTORY OR INDUSTRY
  - SAWMILL
  - HOTEL
  - CHURCH
  - SCHOOL
  - OTHER EDUCATIONAL INSTITUTION
  - COURTHOUSE
  - HALL (T-TOWN, C-COMMUNITY, G-GRANGE)
  - TOWN CLERK OFFICE
  - HIGHWAY GARAGE S-STATE, T-TOWN NF-NATIONAL FOREST
  - FIRE ENGINE HOUSE
  - POST OFFICE
  - PUBLIC LIBRARY
  - HOSPITAL
  - REST HOME
  - U.S. BORDER CUSTOMS STATION
  - STATE POLICE
  - FILLING STATION
  - POWER PLANT
  - POWER SUBSTATION
  - RADIO STATION
  - SUGAR HOUSE
  - MILK DEPOT, GREMERY OR CHEESE FACTORY
  - FRUIT OR PRODUCE PACKING HOUSE
  - SEASONAL INDUSTRY
  - WAREHOUSE
  - ROADSIDE STAND
  - GREENHOUSE
  - STILL (WOOD BY-PRODUCTS)
  - WEIGHING STATION
  - GROUP OF MIXED CULTURAL FEATURES (Figures over building symbols indicate number of units included in a group)
- CONSERVATION AND RECREATION**
- NATIONAL, STATE, TOWN OR MUNICIPAL FOREST OR PARK
  - WILDLIFE REFUGE, MILITARY RESERVATION, ETC.
  - SP — SMALL PARK
  - C — GOLF GROUND OR COUNTRY CLUB
  - A — AMUSEMENT AREA OR HALL
  - RC — RIFLE CLUB

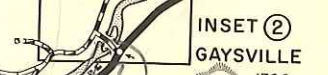
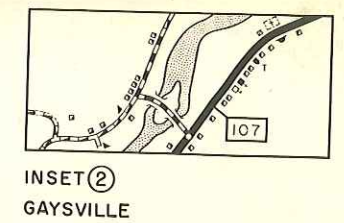

43°50'

N480,000

N460,000

43°45'



- ★ DEAPLAKE ANCHORAGE
  - ★ AIRWAY BEACON
  - AIR NAVIGATION AID
  - ★ LIGHTHOUSE
  - ◇ HEAD OF NAVIGATION
  - TOLL FERRY
- POLITICAL SUBDIVISIONS**
- NATIONAL BOUNDARY
  - STATE BOUNDARY
  - COUNTY BOUNDARY
  - TOWN OR TOWN-CITY BOUNDARY
  - INCORPORATED VILLAGE BOUNDARY
  - URBAN COMPACT BOUNDARY
  - CITY OR INCORPORATED VILLAGE
  - URBAN COMPACT (UNINCORPORATED)
  - FEDERAL AID URBAN AREA BOUNDARY
  - ⊙ STATE CAPITAL
  - ⊙ COUNTY SEAT
  - OTHER CITY OR VILLAGE CENTER
  - HD INCORPORATED FOR HIGHWAYS

- NATURAL FEATURES**
- STREAM
  - MARSH
  - MOUNTAIN RANGE
  - 2150 ○ PROMINENT ELEVATION
  - RESERVOIR, LAKE OR POND

- SKI GYM
  - △ GYMNASIUM
  - △ CAMP SITE
  - △ PICNIC GROUND
  - △ PLAYGROUND, BALL FIELD, ETC.
  - △ BATHING BEACH OR SWIMMING POOL
  - MONUMENT OR HISTORIC SITE
  - HISTORIC BUILDING
  - SCENIC SITE
  - FAIRGROUND
  - △ TOURIST COURT OR MOTEL (NO. UNITS)
  - △ LODGE OR BOYS/GIRLS CAMP
  - △ DRIVE-IN THEATER
  - △ RANGER STATION
  - △ OBSERVATION OR LOOKOUT TOWER
  - △ FISH HATCHERY
  - △ GAME PRESERVE
  - △ FISHING ACCESS AREA
  - △ DOCK, PIER OR MARINA
- MISCELLANEOUS**
- △ TRIANGULATION STATION
  - △ WATER SUPPLY STANDPIPE
  - △ PUMPING STATION
  - △ WATER TREATMENT PLANT OR INSTALLATION
  - △ MINE
  - △ QUARRY
  - △ GRAVEL PIT
  - △ DUMP
  - △ CEMETERY
  - △ DAM
  - △ DAM WITH ROAD
  - △ TREE NURSERY
  - △ SPRING
  - △ TOWN FARM
  - △ PIPE LINE, OIL, G-GAS, W-WATER
  - △ PUMPING STATION (OIL OR GAS)
  - △ VALVE HOUSE

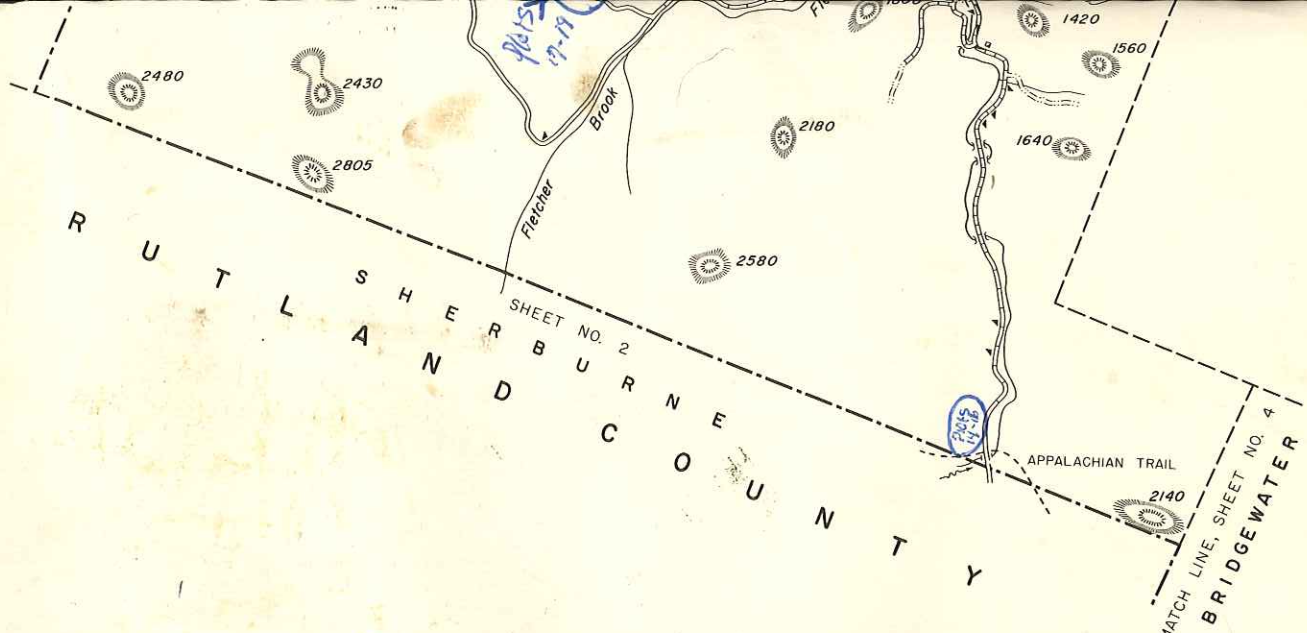

**NOTES**

Polyconic map projection based on U.S. Geological Survey maps. State plane coordinate system superimposed on transverse mercator projection in 20,000-foot grids.

Map prepared with aid of aerial photography dated 1941 and 1962.

Inventory date of cultural features is 1961.

Date of road surface types is Dec. 31, 1966.

Population figures based on 1960 census.

Population of incorporated villages and urban compacts not included in town totals.



GENERAL HIGHWAY MAP  
**WINDSOR COUNTY**  
**VERMONT**

PREPARED BY THE  
**DEPARTMENT OF HIGHWAYS**  
**HIGHWAY PLANNING DIVISION**  
 IN COOPERATION WITH THE  
**U.S. DEPARTMENT OF TRANSPORTATION**  
**FEDERAL HIGHWAY ADMINISTRATION**  
**BUREAU OF PUBLIC ROADS**

*Municipal forests*



1967

N440,000

43°40'

N 420,000

43°50'

72°55'

E 400,000

2,000