

Dry Food Dispenser

Assembly Instructions for

GAT 200/201/202/203 Model

+ Assembling

1. Carefully remove all the parts from the packaging
2. Place the stand in the tray holder by pressing firmly downwards
3. Place the containers in the stand

The dispenser is now ready for use!

+ Disassembly

1. Take the containers out of the stand
2. Remove the lids
3. Pull the tap out
4. Remove the rubber blade by carefully pulling it through to the top

+ Cleaning

1. Wash the parts in warm water with a little soap – never use an abrasive sponge or cloth
2. Make sure that all parts are completely dry before reassembling
3. Insert the rubber blade
(Pay attention to "front" marked on the blade and the pin on the rear side of the blade)
4. Insert the tap into the rubber blade, pushing it all the way through and turning it until you feel a click
5. Place the lids back on the containers

HOW TO USE



WARRANTY

The Zevro™ Indispensable™ Countertop Dispenser is backed by our limited 90-day warranty against manufacturer defects. If your unit should fail due to a manufacturer defect within the warranty period, return it to Zevro in its original packaging along with the original receipt for a full refund or exchange. Only valid in the U.S.A.

z|e|v|r|o

3720 West Touhy Avenue, Skokie, IL 60076 | Tel: 1 800 313 8588 | www.zevro.com

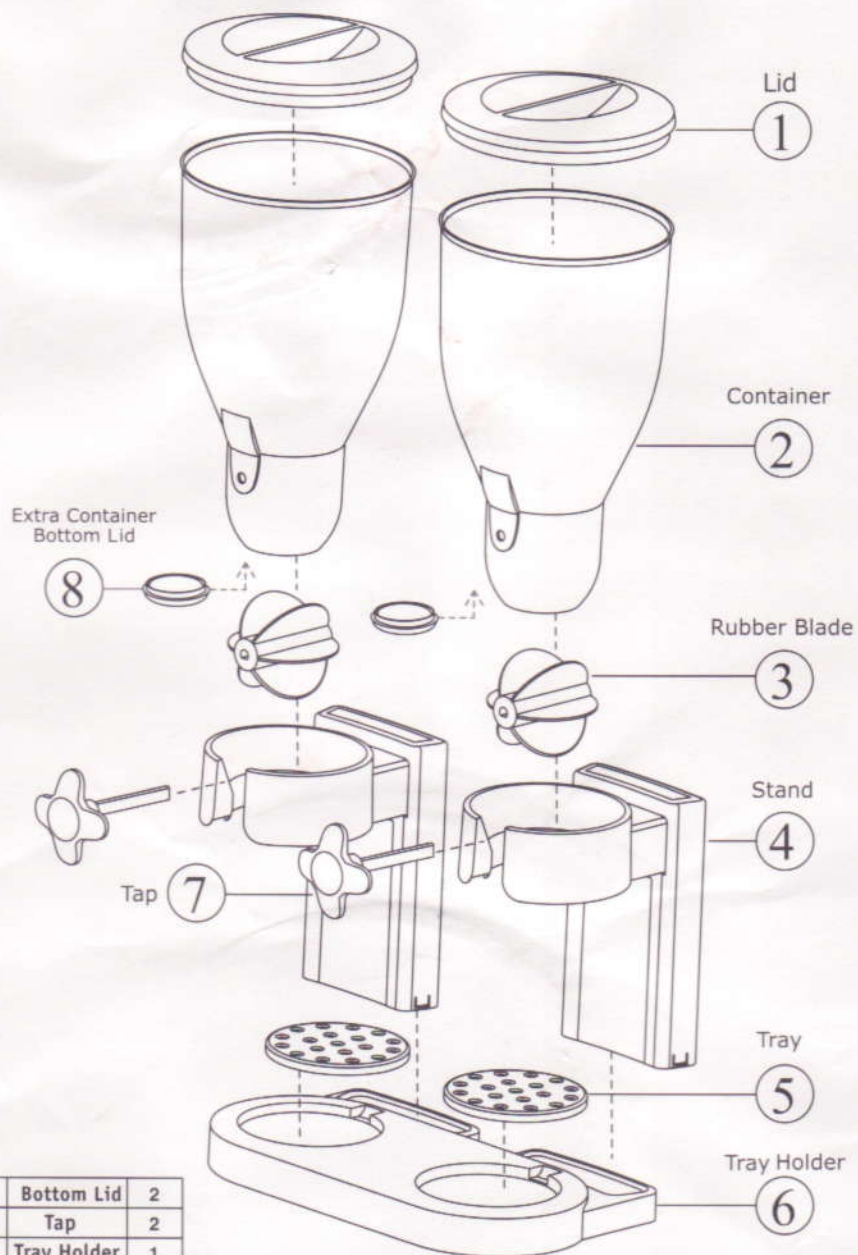

8	Bottom Lid	2
7	Tap	2
6	Tray Holder	1
5	Tray	2
4	Stand	2
3	Rubber Blade	2
2	Container	2
1	Lid	2

MADE IN CHINA