

2012 UVM Student Research Conference

Promoting Research, Scholarship, Creative Work & Innovation

Undergraduate, Graduate, and Medical Students



April 19, 2012
Davis Center, 4th Floor
8:00am - 4:30pm

*Sponsored by the Graduate College, Honors College,
and the Office of the Vice President for Research*



The University of Vermont

Welcome to the 2012 UVM Student Research Conference!

The UVM Student Research Conference (SRC) is a daylong event highlighting the quality and breadth of **undergraduate, graduate, and medical student research** being conducted at the University of Vermont. The purpose of the conference is to promote and facilitate the exchange of interdisciplinary perspectives and to encourage student intellectual growth.

From our first all-student conference in 2008, the SRC has more than doubled in size with more than **365 students participating this year!** As important as the sheer volume of students is the growing breadth of the disciplines they represent. The SRC strives to be a place for students from every college and department, program and spire to engage with their scholarly community, share the results that they have reached, and receive the credit they deserve.

These student projects represent countless hours in the library, the studio, the lab, and the field. Each also reveals the commitment of our faculty to shepherd the next generation through this process of exploration. Today we celebrate the faculty mentors too.

The University of Vermont is **committed to excellence in research, creative works, and scholarship**. We pride ourselves as one of the nation's premier small research universities and we are excited that this annual event -- jointly led by our offices with a mission to advance excellence in research, graduate, and undergraduate education -- truly celebrates our distinctive place as a community of scholars, together.



Vice President for Research and
Dean of the Graduate College
Domenico Grasso, PhD, PE, DEE



Dean of the the Honors College
Saiyid Abu Rizvi, PhD

Dudley H. Davis Center, 4th Floor Map

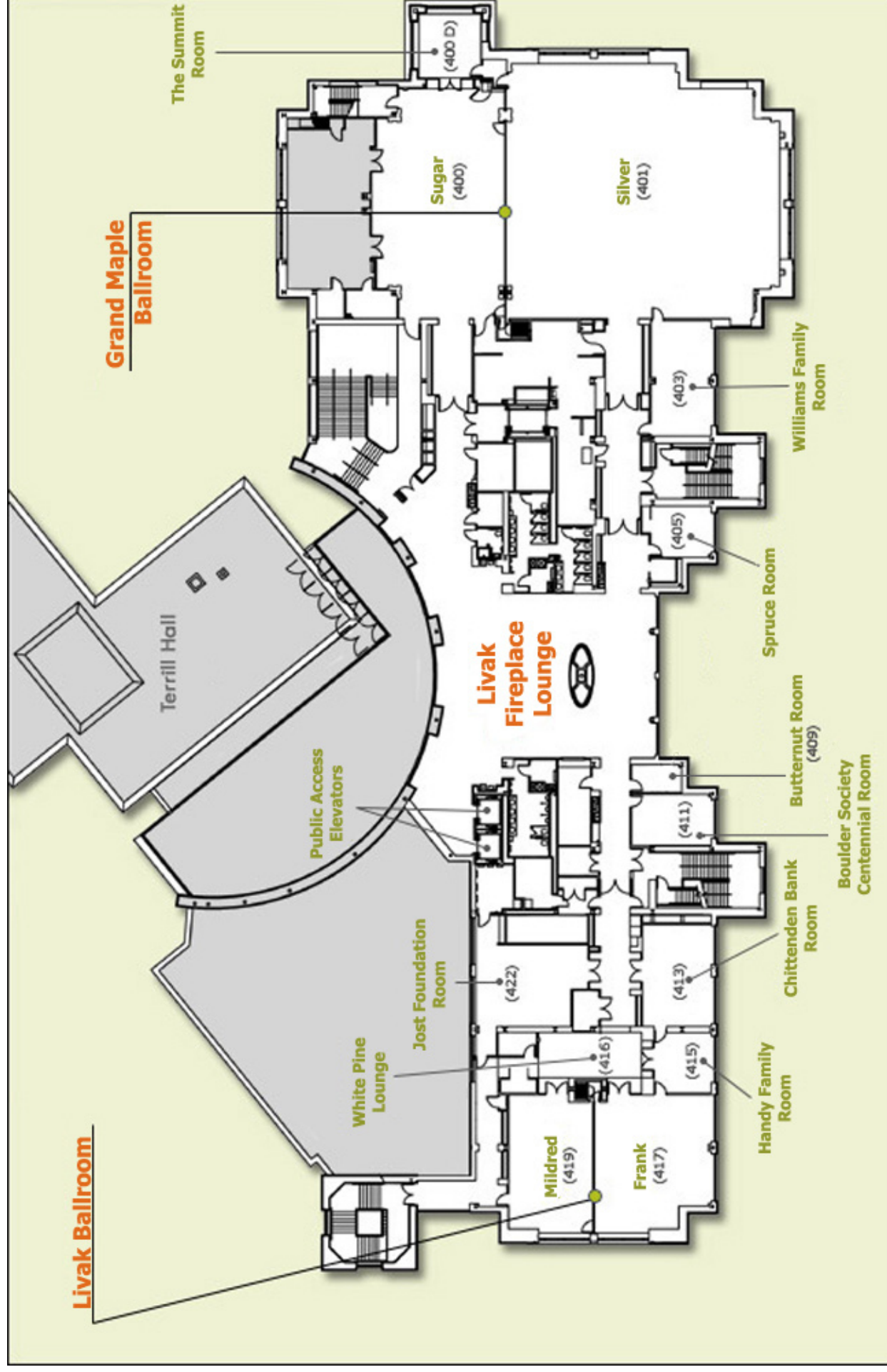

Morning Oral Presentation Schedule

I 8:00

II 9:00

Chittenden
Room 413

8:00 **Chelsea Davidoff**, *Creating Taste of Place for Vermont: An Analysis of Consumers' Willingness to Pay* (Advisor: Jane Kolodinsky)

8:15 **Meagan Pharis**, *Evaluating Nutrition Intervention Programs: A Social Cognitive Theory Approach* (Advisor: Jane Kolodinsky)

8:30 **Matthew Putnam**, *Leverage Points for a Healthier Future: Using Structural Equation Modeling to Understand Obesity* (Advisor: Jane Kolodinsky)

9:00 **Florence Becot**, *Economic Impact and Policy Implications of Food Safety Certification on Produce Farms in Vermont* (Advisor: David Conner)

9:15 **Laurel Valchuis**, *Exploring the Relationship between Engagement with the Food System and Healthy Eating* (Advisor: David Conner)

9:30 **Chloe Wieland**, *Evaluation of Growing Vermont Store* (Advisor: David Conner)

Frank Livak Ballroom
Room 417

8:00 **Frederick Naumann**, *Volatile Testing for Rapid Diagnosis of Tuberculosis* (Advisor: Jane Hill)

8:15 **Josh Tyler**, *Advanced and Integrative Model of Phosphorus loading from High Runoff Events to Identify Critical Source Areas* (Advisor: Jane Hill)

8:30 **Christina Syrrakou**, *Numerical Modeling and Experimental Investigation of the Local Hydrology of a Porous Concrete Site* (Advisor: George Pinder)

9:00 **Abigail Gurall**, *Emotional Vulnerabilities in Women Diagnosed with Infertility* (Jessica Clifton; Advisor: Alessandra Rellini)

9:15 **Kelsey Duquette**, *Endothelial Health and Vaginal Vasocongestion* (Advisor: Alessandra Rellini)

9:30 **Gena Zollman**, *Sexual Scripts Congruency and Sexual Responses in Women* (Advisor: Alessandra Rellini)

Jost Foundation
Room 422

8:00 **Alexandra Miller**, *Laboratory Rearing of the Brown Marmorated Stink Bug for Biological Control Research to Benefit Vermont Growers* (Advisor: Bruce Parker)

8:15 **Guorong Wang**, *Bonding strength, microstructure, and shelf life stability of whey protein-based glue sticks* (Advisor: Ming Guo)

8:30 **Kristen Leclerc**, *Relationship Among Physical Activity, Balance, Stress, and Coping in Adults with Multiple Sclerosis* (Advisor: Susan Kasser)

9:00 **Benjamin Vaughan**, *Synthesis and Characterization of Zinc Complexes and their Reactivity Towards Primary Phosphines* (Advisor: Rory Waterman)

9:15 **Karla Erickson**, *Explorations in main group mediated catalysis: phosphine dehydrocoupling and the search for silane activation* (Advisor: Rory Waterman)

9:30 **Neil Mucha**, *Catalytic Dehydrocoupling of Phosphines Towards the Preparation and Characterization of π -conjugated Materials* (Advisor: Rory Waterman)

Mildred Livak Ballroom
Room 419

8:00 **Jordan Armstrong**, *Ovipositional ability of geographic populations of Colorado potato beetle *Leptinotarsa decemlineata* on native and novel host* (Advisor: Yolanda Fanslow)

8:15 **Victor Izzo**, *Plant-mediated diapause initiation in *Leptinotarsa decemlineata*, the Colorado potato beetle* (Advisor: Yolanda Fanslow)

8:30 **Jacqueline LeBlanc**, *Alternative Food Network Infrastructure: Food Hub Development in Vermont* (Advisor: David Conner)

9:00 **Daniel DePuccio**, *Synthesis and characterization of mesoporous tungsten oxide spheres* (Advisor: Christopher Landry)

9:15 **Alexandra Duncan**, *Gadolinium-Phosphate Complexes with Large Relaxivities Immobilized on Silica Particles for Magnetic Resonance Imaging (MRI)* (Advisor: Christopher Landry)

9:30 **Alden Clemments**, *Intracellular Trafficking of Silica Microparticles* (Advisor: Christopher Landry)

Williams Family
Room 403

8:00 **Bijoux Bahati**, *A Refugee Young Adult's Acculturation Experiences and Processes in a United States High School: An Autoethnography* (Advisor: Susan Comerford)

8:15 **Sarah Bush**, *We're Not Made of Metal* (Advisor: Cameron Davis)

8:30 **Kelly Swindlehurst**, *A Statewide Survey of Response to Instruction (RtI) Implementation* (Advisor: Katharine Shepherd)

9:00 **Jon Black**, *Wearing My Veins* (Advisor: Anthony Grudin)

9:15 **Amy Goodnough**, *Explaining an exception: Generating Hungarian verbal affix order* (Advisor: Emily Manetta)

9:30 **Theodora Ziolkowski**, *Excavating Desire* (Advisor: Major Jackson)

As a courtesy we ask that you enter the Oral Presentation session during the break and stay for the entire presentation session.

III 10:00

<p>10:00 Xiaoxi Liu, <i>Construction of N-Heterocycles via Aza-Prins Cyclization and 1,3-Dipolar Cycloaddition</i> (Advisor: Stephen Waters)</p> <p>10:15 Michael McCormack, <i>Application of a 2-aza-Cope 1,3-Dipolar Cycloaddition Cascade Toward the Total Synthesis of VM55599</i> (Advisor: Stephen Waters)</p> <p>10:30 Ali Bayir, <i>Macrocycles through fragmentation of bicyclic ring systems</i> (Nikolay P. Tsvetkov; Advisor: Matthias Brewer)</p>	<p>11:00 Alyssa Frediani, <i>The Nesting Ecology of Diamondback Terrapins</i> (Advisor: Richard Paradis)</p> <p>11:15 Karuna Jobanputra, <i>Gender, dowry/brideprice, and land in southern Tamil Nadu and Southern Rajasthan: A participatory rural appraisal</i> (Advisor: Stephanie Kaza)</p> <p>11:30 Aaron Witham, <i>Organizational Characteristics that Relate to a Central Presence in Hyperlink Networks in the Context of Sustainable Transportation</i> (Advisor: Richard Watts)</p> <p>11:45 Rebecca Pincus, <i>Impact of Climate Change on US Coast Guard Strategy in the Arctic</i> (Advisor: Saleem Ali)</p>
<p>10:00 Kaitlyn Vitez, <i>Reconsidering Female Circumcision</i> (Advisor: David Houston)</p> <p>10:15 Emily Jessep, <i>Darker Shades of Green: The Dilemmas of Green Consumerism</i> (Advisor: Luis Vivanco)</p> <p>10:30 Alex Lehning, <i>The "Jewish Question" in German-Italian Relations, 1933-1943</i> (Advisor: Francis Nicosia)</p>	<p>11:00 Nicholas Allgaier, <i>Reverse Engineering the Human Brain</i> (Advisor: Christopher Danforth)</p> <p>11:15 Suma Desu, <i>The Happiness of Language</i> (Advisor: Christopher Danforth)</p> <p>11:30 Eitan Pechenick, <i>Joining Words into Meaningful Phrases through Virtual Text Compression</i> (Advisor: Peter Dodds)</p> <p>11:45 Kameron Harris, <i>Chaotic social contagion: From zombies to hipsters</i> (Advisor: Peter Dodds)</p>
<p>10:00 Yanting Zhang, <i>Orthogonality Catastrophe in Quantum Sticking</i> (Advisor: Dennis Clougherty)</p> <p>10:15 Meghan Thompson, <i>Engineered log jam design and its impact on channel morphology: a flume experiment</i> (Advisor: Maeve McBride)</p> <p>10:30 Zhao Li, <i>Descriptive Clustering Meta Search Engine</i> (Advisor: Xindong Wu)</p>	<p>11:00 Meagan Quinlan, <i>Functional expression of wild type cGMP-dependent protein kinase Ia in E.coli</i> (Advisor: Wolfgang Dostmann)</p> <p>11:15 Whitney Roth, <i>Women and Their Essential Role in the Development of Purgatory</i> (Advisor: Vicki Brennan)</p> <p>11:30 Ariel Robbins, <i>Frenchwomen and the Vichy Ideal: Social Policy, Choice, and Daily Life under German Occupation in World War II</i>. (Advisor: Steven Zdatny)</p> <p>11:45 Daniel Garcia, <i>Corporate Social Responsibility: A Panacea to an Economic Malaise</i> (Advisor: Stephanie Seguino)</p>
<p>10:00 Jacob Menken, <i>Crystal Structure Study of Tourmalines from the Stewart Mine, California</i> (Advisor: John Hughes)</p> <p>10:15 Rebecca Calder, <i>Expression and biological activity of recombinant bovine IL-22: a key cytokine in mucosal defenses</i> (Advisor: John Barlow)</p> <p>10:30 Todd Stanley, <i>Evaluating the Nutritional Status of the Thru-Hiking Community</i> (Advisor: Jean Berino)</p>	<p>11:00 Catherine McGoldrick, <i>Post-Relocation Analysis of Compost Runoff at the Intervale Composting Facility, Burlington, VT</i> (Advisor: Donald Ross)</p> <p>11:15 Thomas Gebhard, <i>Monitoring E. coli levels throughout the Englesby Brook: Summer 2011</i> (Advisor: Eamon Twohig)</p> <p>11:30 Rachel Brooks, <i>Proteomic Signatures of Experimentally Manipulated Pitcher Plant Communities and Their Corresponding State Changes</i> (Advisor: Nicholas Gotelli)</p> <p>11:45 Danika Frisbie, <i>An Evolutionary Analysis of the "Organics Recycling" Industry in the U.S.</i> (Advisor: Rocki-Lee DeWitt)</p>
<p>10:00 Yucan Zhang, <i>Light Regulation of Nodulation Through Plant Hormone Signaling Network</i> (Advisor: Jeanne Harris)</p> <p>10:15 Ryan Melnichuk, <i>Greenhouse Gas Emissions from Forest Invaders</i> (Advisor: Josef Gorres)</p> <p>10:30 Tharshani Nishanthan, <i>Role of soil microbial extracellular enzymes in soybean cyst nematode suppressive soil</i> (Advisor: Deborah Neher)</p>	<p>11:00 Eliza Gardner-Morse, <i>Reproductive Division of Labor in Forced Associations of Pogonomyrmex barbatus Queen Ants</i> (Advisor: Sara Cahan)</p> <p>11:15 Allison Neal, <i>How might transmission affect the sex ratio of malaria parasites?</i> (Advisor: Joseph Schall)</p> <p>11:30 Molly Morrissey, <i>Assessing metabolic exertion during diel vertical migration of an omnivorous macro-invertebrate</i> (Advisor: Jason Stockwell)</p> <p>11:45 Liam Donnelly, <i>107 genes found to be upregulated in a phagocytic Entamoeba histolytica fraction may be upregulated in response to phagocytic stimuli</i> (Advisor: Christopher Huston)</p>

IV 11:00

Afternoon Oral Presentation Schedule

Chittenden
Room 413

Frank Livak Ballroom
Room 417

Jost Foundation
Room 422

Mildred Livak Ballroom
Room 419

Williams Family
Room 403

V 12:30

12:30 **Mike Archer**, *Advertising Methods of Vermont Agribusiness Entrepreneurs* (Advisor: David Conner)

12:45 **Tad Cooke**, *Feedstock Development and Analysis for On-Farm Compost Energy Systems* (Erick Crockenberg; Advisor: Allen Matthews)

1:00 **Rachel Park**, *Galen and William Harvey: A Comparative Analysis of the Theories of the Circulatory System* (Barbara Rodgers)

12:30 **Jake Williams**, *Eliciting the shape of human reasoning from its echo in text-frequency data* (Advisor: Christopher Danforth)

12:45 **Catherine Bliss**, *Twitter reciprocal reply networks exhibit assortativity with respect to happiness* (Advisor: Christopher Danforth)

1:00 **Lewis Mitchell**, *Finding novel applications for big data from social media* (Advisor: Christopher Danforth)

12:30 **Caitlin Patterson**, *Calibration of a Fourier Transform Infrared Spectrometer and a Perspective on the Importance of Vehicle Emission Testing Procedures* (Advisor: Britt Holmen)

12:45 **Qiong Liu**, *Examining spatial autocorrelation for obesity in northern new England* (Advisor: Brian Lee)

1:00 **Richard Nam**, *Intra-household Vehicle Allocation and Transportation System Efficiency* (Advisor: Brian Lee)

12:30 **Nikolaos Fytillis**, *A Bayesian approach to genetic data (PCR) to better understand fish disease dynamics* (Advisor: Donna Rizzo)

12:45 **Joseph Krupa**, *Consumer Survey Data Analysis for Market Adoption of Plug-in Hybrid Vehicles* (Advisor: Donna Rizzo)

1:00 **Nathan Belz**, *Ridesharing and the Journey to Work in Vermont: Modeling Composition of Vehicle Occupancy using the 2009 National Household Travel Survey* (Advisor: Lisa Aultman-Hall)

12:30 **Maya Perry**, *Community Development from Theory to Practice* (Advisor: Andrea Grayson)

12:45 **Julie Williams**, *Increasing Disaster Resiliency in Mobile Home Park Communities Through Youth Disaster Preparedness Education: A Pilot Project* (Advisor: Daniel Baker)

1:00 **Jonathan Bond**, *Investigating Vermonters' Disaster Preparedness Perceptions and Practices: Findings from a Statewide Survey* (Advisor: Daniel Baker)

VI 1:30

1:30 **Joshua Bakelaar**, *Impacts of Season Extension Pasture Management in Vermont* (Advisor: Deborah Neher)

1:45 **Kristin Williams**, *Spatial effects of roads on soil nematode communities in forested areas of vermont* (Advisor: Deborah Neher)

2:00 **Rebecca Bourgault**, *Catchment-scale analysis of interactions between soils and water at Hubbard Brook, NH* (Advisor: Donald Ross)

1:30 **Sebastian Castro**, *Evaluation of sampling methods and statistical models for predicting fruit load on individual Coffee arabica trees* (Advisor: Victor Mendez)

1:45 **Lily Calderwood**, *Evaluation of mixed cover crop as organic, biological pest control in hops* (Advisor: Heather Darby)

1:30 **Kristina Lafferty**, *The Association between the Need to Belong and Relational Aggression: A Moderating Role of Rejection* (Advisor: Dianna Close)

1:45 **Leah Marvin-Riley**, *Gun Control and Policy Frames* (Advisor: Alec Ewald)

2:00 **Morgan Saunders**, *The Judicial Transformation of Political Immigration Questions* (Advisor: Alec Ewald)

1:30 **Benjamin Lindsey**, *"Organized Crime Against Civilization": The Congressional Investigation Of Liberated Concentration Camps In 1945* (Advisor: Nicole Phelps)

1:45 **Michelle Sigiel**, *Creating the Alien Image: Roman Dmowski's Antisemitism in 20th Century Poland* (Advisor: Francis Nicosia)

2:00 **Gianna Vannelli**, *The correlation between breath-methane levels and the quantity and structure of methanogens in the human gastrointestinal tract* (Advisor: Andre-Denis Wright)

1:30 **Tommy Goldmani**, *Escaping Irene (Three Points of View)* (Alex Litwin; Advisor: Carol Howe)

1:45 **Adam Connor**, *The Poetics of Purification: Orestes' Spiritual Revival (Eum. 235-43)* (Advisor: Mark Usher)

2:00 **Brent Cohen**, *Morality Without Objective Value* (Advisor: Terence Cuneo)

As a courtesy we ask that you enter the Oral Presentation session during the break and stay for the entire presentation session.

VII 2:30

<p>2:30 Jeffrey Tonn, <i>Creating Taste of Place for Vermont: An Analysis of Consumers' Willingness to Pay</i> (Advisor: Jane Kolodinsky)</p> <p>2:45 Alexander Hilshey, <i>An Activity-Based Travel-Demand Modeling Approach to Estimating Electric Vehicle Charging Load</i> (Advisor: Paul Hines)</p> <p>3:00 Rachel Koh, <i>Modeling Demonstrates that Gene Circuit Architecture Controls Phenotypic Variability in a Bacterial Persistence Network</i> (Advisor: Mary Dunlop)</p>	<p>3:30 Naciim Benkreira, <i>Cuba Skate: facilitating the cuban skateboard revolution in Habana, Cuba</i> (Advisor: Joshua Farley)</p> <p>3:45 Marigo Farr, <i>Soil Quality and Climate Implications of Agroecological Practices on Vermont Farms</i> (Advisor: Joshua Farley)</p> <p>4:00 Brian Kelly, <i>Governance Network Design: A Case Study Analysis of Vermont</i> (Advisor: Joshua Farley)</p> <p>4:15 Colin Arisman, <i>Ecological and Economic Sustainability through Cooperative Agriculture: Scaling up agroecology through payments for ecosystem services in the Intag Region of Ecuador</i> (Advisor: Joshua Farley)</p>
<p>2:30 Kalyn Weber, <i>The Relationship Between Twitter and Student Engagement and Exam Scores in An Advanced Nutrition Course</i> (Advisor: Stephen Pintauro)</p> <p>2:45 Kyle Bessette, <i>Gender in the Kitchen</i> (Advisor: David Houston)</p> <p>3:00 Claudia Abbiati, <i>Assessing the Validity of a Direct Measure of Attitudes of Preschoolers Who Stutter</i> (Advisor: Barry Guitar)</p>	<p>3:30 Caitlin Campbell, <i>Livestock depredation by large carnivores: An analysis of human-wildlife conflict in Ehi-rovipuka, Namibia.</i> (Advisor: James Murdoch)</p> <p>3:45 Kalle Fjeld, <i>A Cinematic Perspective on the Children of North African Immigrants in France: Interpreting the Immigrant Experience through the Film Lens</i> (Advisor: Meghan Emery)</p> <p>4:00 Emily Bird, <i>The Socioeconomic Impact of Hydroelectric Dams on Developing Communities</i> (Advisor: Saleem Ali)</p> <p>4:15 Anya Gedrath-Smith, <i>Time for Tea: The Sustainable Development of Tea Tourism in Nepal</i> (Advisor: Pablo Bose)</p>
<p>2:30 Brad Lanute, <i>Assessing Urban Sprawl Metrics and their Applicability to Chittenden County, VT</i> (Advisor: Austin Troy)</p> <p>2:45 David Kuhn, <i>Agroforestry in the Atlantic forest region of Brazil: Providing framework for implementation through stakeholder participation</i> (Advisor: Cecilia Danks)</p> <p>3:00 Dmytro Karabchuk, <i>Factors Influencing Aboveground Live Biomass of Carpathian Spruce</i> (Advisor: William Keeton)</p>	<p>3:30 Rebecca Standish, <i>Importance of Biosecurity on Vermont Farms</i> (Advisor: Julia Smith)</p> <p>3:45 Xiaozheng Song, <i>Estrogen receptor-beta agonist diarylpropionitrile counteracts the estrogenic activity of estrogen receptor-alpha agonist propylpyrazoletriol in the mammary gland of ovariectomized rats</i> (Advisor: Zhongzong Pan)</p> <p>4:00 Hannah Facey, <i>Examination and identification of bacterial species present in the forestomach of the Alpaca (Vicugna pacos)</i> (Advisor: Andre-Denis Wright)</p> <p>4:15 Ashley Jones, <i>Does insecticidal spraying impact parasite prevalence in Chagas disease vectors?</i> (Advisor: Lori Stevens)</p>
<p>2:30 Pushwinder Kaur, <i>To Determine the Concentration and Enrichment of Glutathione in Human Plasma using Liquid Chromatography-Mass Spectrometry</i> (Advisor: Dwight Matthews)</p> <p>2:45 Nezar Al-Bataineh, <i>Synthetic Methods for Diazenium Salts</i> (Advisor: Matthias Brewer)</p> <p>3:00 Pierre Galea, <i>Identifying and Quantifying Volatile Fear Response in Humans</i> (Advisor: Jane Hill)</p>	<p>3:30 Tera Fazzino, <i>Daily Craving Reports from Drinkers Not in Treatment</i> (Advisor: Gail Rose)</p> <p>3:45 Ariel Bailly, <i>Face-name Recognition: A brain fMRI study</i> (Advisor: Julie Dumas)</p> <p>4:00 Joanne Kalisz, <i>"Teen-ageism": Adolescents' Internalization, Acceptance, and Behavioral Confirmation of Stereotypes About Teens</i> (Advisor: Carol Miller)</p> <p>4:15 Andrew Philips, <i>Public Assets Institute</i> (Advisor: Frank Bryan)</p>
<p>2:30 Elizabeth Sander, <i>Sampling Effects in the Estimation of Biodiversity Using Hill Numbers</i> (Advisor: Nicholas Gotelli)</p> <p>2:45 Michael Reardon, <i>Interaction of Unstable Modes in a Solid Propellant Combustion Model</i> (Advisor: Jun Yu)</p> <p>3:00 Narine Manukyan, <i>Automated Discovery of Multivariate Associations in Large Time-Varying data sets: a Healthcare Network Application</i> (Advisor: Margaret Eppstein)</p>	<p>3:30 Dirk Jonathan Rodricks, <i>Cross Cultural Conundrum: Supporting students who live between worlds</i> (Advisor: Dorian McCoy)</p> <p>3:45 Jacqueline Drouin, <i>Assessing the Long-term Impact of Participation in the Governor's Institute on Asian Cultures in China</i> (Advisor: Holly Busier)</p> <p>4:00 Ashley Michelle Fowler, <i>"I Know I Can Be What I Wanna Be": Career Development for First-Generation College Students</i> (Advisor: Robert Nash)</p> <p>4:15 Saveta Saini, <i>Use of Positive Behavioral Intervention Supports for Preschoolers in a Refugee Resettlement Community</i> (Advisor: Jennifer Hurley)</p>

VII 3:30

Student	Location	Title	Advisor
Sarah Abdalla	5A	Identification of the Factor V Region Mediating its Endocytosis by Megakaryocytes to Form	Beth Bouchard
Emily Aldrich	26A	Preparation Methods for Stable Carbon Isotope Analysis of Tree Rings (Catherine Jenkins)	Andrea Lini
Pedro Alvarez-Ortiz	14A	Expression and Function of Glutactin in Drosophila Larvae and Adults	Jim Vigoreaux
Juan Alvez	70A	Dairy management, ecosystem services and sustainable livelihoods ()	Jon Erickson
Krist Aploks	13A	The Effects of the Xenobiotic Endocrine Disruptor Bisphenol A on the Thyroid Hormone Receptor	Frances Carr
Meghan Arpino	45A	Lead and Phthalates: Parental Awareness and Environmental Health Resources	Charles Hulse
Page Atcheson	46A	Communicating Climate Change	Brian Tokar
Francis Ayombil	8A	Prethrombin-1, the gla-domainless prothrombin intermediate, is activated efficiently to thrombin	Paula Tracy
Gussie Belisle	78A	Evaluation of the Number of Iterations Needed for Convergence with Astonish Reconstruction	Kenneth Allen
Paul Beliveau	36A	Interactive Robot Simulation Environment	Joshua Bongard
Dylan Bellavance	48A	Obese, Pre-pubertal Children Display Significant Health Risk Factors According to Adult Metabolic	Connie Tompkins
Natalie Bishop	93A	Grassroots Neighborhood Leaders in Vermont: A Qualitative Analysis of the Rewards, Challenges,	Lynne Bond
Stefan Boas	16A	DTI as a diagnostic tool for mTBI (Ali Sadeghi)	Kalev Freeman
Sureewan Bumrunghthai	81A	Invasive Cervical Carcinoma Genetic Heterogeneity: Biological and Clinical Significance	Mark Evans
Ana Camposeco Jacobs	21A	Role of noise in gene expression in the multiple antibiotic resistance (mar) network of Escherichia coli	Mary Dunlop
Christopher Cardona	63A	Investigating Whether the Growth Factor Induced Phosphorylation of the Catalytic Subunit of PKA	Paula Deming
Samya Chakravorty	15A	Functional Requirement of the Flightin Amino Terminal Region for Flight and Courtship Song	Jim Vigoreaux
Paul Chambers	2A	Cultivating Happy Campers	Jeanne Shea
Kanita Chaudhry	7A	Quantification of Protein Phosphorylation in Cardiac Troponin I and Myosin Binding Protein-C	Dwight Matthews
Leah Cipri	84A	Tobacco Cessation Intervention Among Emergency Department Patients (Abby Wager)	Kalev Freeman
Amy Clay	59A	Healthy Vending in State Government: Is It Making a Difference?	Amy Nickerson
Benjamin Coleman	31A	Social Validity of using Comic Strip Conversations and Social Stories to target core deficits in children	Tiffany Hutchins
Elise Corriveau	80A	Female Adolescent Refugees: Views of Health	Sarah Abrams
Sandra Cronauer	53A	Powder X-ray Diffraction Analysis of Greenland Ice Sheet Sediments	John Hughes
Alysha Desrosiers	66A	Evaluation of a noninvasive device to measure CO levels	Kalev Freeman
Anna Drake	76A	Novel protein-protein interactions induced by phosphorylated Protein Kinase A Catalytic Subunit α	Paula Deming
Midori Eckenstein	65A	Borrelidin 194 Effects on VHL Deficient Cancer Cells	Karen Lounsbury
Katherine Ekstrom	29A	The Effects of Text Genre on the Intensity and Localization of Cortical Activation in Normal Adult	Michael Cannizzaro
Chelsea Emond	89A	Psychological Control and Responses to Stress in Emerging Adulthood	Jamie Abaied
Catherine Evans	40A	The Achilles Kids Virtual Marathon Program and its Impact on Students With Disabilities	Jennifer Hurley
Chelsea Fifeild	95A	The Professional Interface of Intimate Partner Violence and Restorative Justice	Gale Burford
Kate Fournier	67A	Vermont Legislative Research Service	Anthony Gierzynski
Claire Freson	49A	Improving Exercise Adherence Through Online Journaling Following Physical Therapy Treatment for	Sharon Henry
Kelsey Gero	60A	Incorporating a Skills-Based Nutrition Curriculum in a High School Health Class	Amy Nickerson
Sarah Gillett	28A	An Approach for Defining Cognitive Decline in Epidemiologic Studies	Mary Cushman
Talia Glesner	42A	Kids-A-Part: A Realistic Evaluation of a Program for Children of Incarcerated Parents	Herman Meyers
Brianna Goddard	91A	Subjective Well-Being Predictors in the College to Career Transition	Keith Burt
Jen Grauer	99A	Ecological Niche Modeling of Pogonomyrmex Hybrid Lineages	Sara Cahan
Dan Hagan	62A	Conjugate heat transfer and wall reaction in computational fluid dynamics (Ryan Crocker)	Yves Dubief
Kristen Hardgrove	86A	The effects of socioeconomic status on the use of aggression in males (Mary Yvette Collett)	Dianna Close
Rebecca Harvey	27A	The Formation and Aging of Organic Aerosols Under Atmospherically Relevant (Shashank Jain)	Giuseppe Petrucci
Kristin Heller	22A	Testing the Signals that Job Seekers Receive From a Recruiting Organization's Community	David Jones
Samuel Hellman	56A	Differentiating in situ and Reworked Sediments from the Miocene Choptank Fm, (Emily Siegel)	Paul Bierman
Peter Helm	88A	Shared Subjective Experience as a Catalyst for Prosocial Harmony: Study on Quieting the Ego	Elizabeth Pinel
Zachary Hirsch	3A	Did Borders Really Leave Church Street? The Politics of Discipline on Burlington, Vermont's Church St.	Luis Vivanco
Justin Hoekstra	97A	Large Format Abstraction in Action	Steve Budington
Jordan Humble	18A	Determination of the role of retromer subunit VPS26C in arabidopsis root hair growth	Mary Tierney
Alyssa Iveson	51A	Literature Review of the Identification and Invasive Potential of Acer mono	Margaret Skinner
Michael Kirk	33A	Opportunities and Obstacles in Accessing Local Markets for Small and Medium-Scale Livestock	David Conner
Taylor Kravits	44A	Phosphorus and E.Coli Removal from Wastewater Using Hybrid Steel Slag and Plant Charcoal Filters	Aleksandra Drizo

Student	Location	Title	Advisors
Max Kravitz	19A	The Effects of Nicotine on the Development of Retinal Ganglion Cells in the Chick Retina	Rae Nishi
Joseph Labrum	20A	Phylogeography of Colorado Potato Beetle (<i>Leptinotarsa decemlineata</i>): inferring the history	Yolanda Fanslow
G. Michael LaMuraglia II	10A	Opsonin-independent phagocytosis of gram-positive bacteria	Daniel Weiss
Crystal Latham	82A	Study of Modal Patterns and Dynamic Emission Characteristics in Pulsar B1822-09	Joanna Rankin
Kathryn Lawson	61A	Sustainable Food Systems: Using problem-based learning to educate tomorrow's nutrition	Amy Nickerson
Tabatha Leahy	94A	The relationship between self-reported physical activity and academic success	William Falls
Caleb Liberman	17A	The Effects of Traumatic Brain Injury on Bladder Function	Katarina Zvarova
Kali Lockerby	85A	Daily Alcohol Use And Relationship Harmony Reports Among Drinkers Not In (Tera Fazzino)	Gail Rose
Travis Mann-Gow	92A	CT Exams for Traumatic Injuries	Kalev Freeman
Christine McNiff	55A	Geometric Variability and Spatial Extent of an Acadian Dome and Basin Fold Interference	Laura Webb
Chelsea McShane	32A	Differences in Mental State Talk Between Mothers and their Typical Developing Children v	Tiffany Hutchins
Kathryn Miller	39A	Mathematics Instruction Within an RTI Framework	Holly Busier
Kheng Newick	25A	Targeting redox homeostasis in malignant mesothelioma	Nicholas Heintz
Ly Nguyen	96A	An Exploration of Risk and Protective Factors for Risky Behaviors among Asian American	George Leibowitz
Alison Nihart	72A	Identifying a cohesive urban agriculture policy for Burlington, VT	Stephanie Kaza
Marley Nordmeyer	30A	The Expression of Mental State Terms: A Comparison of Children with ASD and Typically	Patricia Prelock
Leah Novinger	23A	Characterizing the Humoral Response to Breast Cancer in an Individual Patient	David Krag
Elyse Ogletree	87A	The Impact of Sibling Relationships on the Socialization of Relationally Aggressive Behaviors in	Dianna Close
Elizabeth Olliver	52A	Impacts of large storms on Vermont Lakes: A case study from Lake Rescue, Ludlow, VT	Andrea Lini
Peter Oswald	43A	Exploring Marketing Strategies and Their Effectiveness for Vermont Wine and Cheese Farmers	Chyi-Lyi Liang
Shreoshi Pal Choudhuri	12A	Receptors and Signal Transduction Pathways for L-Amino Acids	Eugene Delay
Krithika Rao	24A	Protein Complexes as Novel Therapeutics for Myocardial Infarction.	Jeffrey Spees
Katharine Rifken	90A	The Effects of Exercise on a Set-Shift Task in Female Ovariectomized and non-Ovariectomized	John Green
Gain Robinson	74A	The Effect of Secretin on Extinction of Eyeblick Conditioning	John Green
Carolyn Roman	77A	PACAP and PAC1 receptor signaling in (KR Lezak, M Kocho-Schellenberg, and G Missig)	Victor May
Abigail Ruksznis	54A	Integration of Structural Analysis, an EMI Survey, and Hydrogeology in the Plainfield	Keith Klepeis
Geoffrey Schaubhut	73A	Regulation of Impulsive Circuitry: Function of Emotional Faces	Alexandra Potter
Noelle Sevoian	34A	How farm to institution actors make sense of the supply chain they are a part of: Interviews	David Conner
Michael Shaw	9A	Nasogastric Tube Insertion Using Midazolam in the) (Emily Pattison)	Kalev Freeman
Brittany Smith	1A	Factors That Influence Taxpayer Compliance When Reporting Gambling Income	Barbara Arel
Lauren Stackhouse	75A	Using fNIR to explore prefrontal cortical activation across different levels of discourse structure	Michael Cannizzaro
Tessera Strand	6A	Kinetic Assay Analysis of Single-Point Mutation of Histidine tRNA Synthetase Escherichia coli	Christopher Francklyn
Loren Teetelli	4A	Chimú Domestic Architecture on Cerro Huancha, Sinsicap Valley, Peru	Deborah Blom
Ethan Thompson	35A	Consumer Preferences and Market Potential for Artisan & Farmstead Cheese	Qingbin Wang
Leslie Turner	58A	The State of Food Systems Planning and Implementation Network Governance in the U.S.	Christopher Koliba
Helena Vladich	71A	High Resolution Remote Sensing Data and Participatory Spatial Analysis as a tool for	Saleem Ali
Abigail Wager	57A	Systems Biology of Coagulation and Trauma-Induced Coagulopathy (Leah Cipri)	Kalev Freeman
Tamar Walker	83A	Self Care, Family-Based Caregiving, and Community Care-Seeking Behavior Among Elderly	Jeanne Shea
Catherine Webster	68A	Assessing Road Drainage Contributions to Lake Champlain Water Quality	Beverley Wemple
Aiko Weverka	50A	Exploring the relationship between remotely sensed metrics of forest canopy condition	Jennifer Pontius
Katharine White	69A	Remote sensing of Spring Phenology: Method development and temporal trends	Jennifer Pontius
Julia Williams	79A	(Kristi Ditmarson, Julia Liebert, Kelly Schultz, Chelsea Purinton, Elyse Corriveau, Danielle Goldstein, Megan Corbett, Erika Sabattis & Molly Wallner)	Hendrika Maltby
Sara Williams	98A	Factors affecting coyote (<i>Canis latrans</i>) occupancy in the Champlain Valley, Vermont	James Murdoch
Melissa Woolpert	64A	Staphylococcus aureus Transmission and Control in a Robotic Milking Herd	John Barlow
Evan Yandell	37A	Exploring Methods for Evolving Modularity in Artificial Neural Networks	Joshua Bongard
Elizabeth Yasewicz	11A	CREB in Pathogenesis of Mesothelioma	Arti Shukla
Yunfei Zhao	38A	Spontaneous Evolution of Modularity in Robot Neural Networks for Object Manipulation	Joshua Bongard
Sara Ziegler	41A	Efficacy and ecological impact of Neem Oil and <i>Bacillus thuringiensis</i> as control agents	Josef Gorres
Abigail Zuckerman	47A	Food Justice in Vermont: Exploring Community Awareness of Bias-Free Policing Initiatives	Victor Mendez

Afternoon. Poster Presentation Schedule	Student	Location	Title	Advisor
	Ben Albertson	12B	The Effect of Exercise Intensity On the Durability of Exercise-Induced Changes in Mood	Jeremy Sibold
	Alexandra Arntsen	46B	Internal Ice layer Mapping and Geophysical Analysis of Jakobshavn Glacier, Greenland	William Bowden
	Joshua Auerbach	30B	On the Relationship Between Environmental and Morphological Complexity in Evolved Robots	Joshua Bongard
	Emily Bates	78B	The Influence of the Human Gut Microbiome on Crohn's Disease	Indra Sarkar
	Monica Beers	49B	Effect of Compost Treatments on Generalist Predator Abundance in Agroecosystems	Yolanda Fanslow
	Kira Benson	80B	Dose dependent effects of mitochondrial targeted nitroxides on malignant mesothelioma cells.	Nicholas Heintz
	Lucas Bernacki	18B	An Investigation of the Testudine Mitochondrial Control Region	Charles Kilpatrick
	David Bernstein	71B	Decision Support Tool for Mechanical Ventilation Based on Fuzzy Logic	Jason Bates
	Evelyn Boardman	42B	Evaluating the Hilsenhoff Biotic Index as a Biological Monitoring Indicator in Stream Ecosystems	Alan McIntosh
	Evan Border	87B	Quantum Monte Carlo Measurements of the Superfluid Density of Helium-4	Adrian Del Maestro
	Austin Brooks	62B	Determinants of Gestational Weight Gain and Internet Usage Among Vermont WIC Participants	Amy Nickerson
	Sam Brown	35B	Attribute Prediction from Messages by Analysis of Nonverbal Characteristics	Robert Snapp
	David Buckingham	31B	Evolving Adaptive Sampling Algorithms	Joshua Bongard
	Matt Carralero	6B	Characterizing the Potential Angiogenic Effects of Threonyl-tRNA Synthetase	Karen Lounsbury
	Brittany Carroll	5B	Amifostine Alleviates Cyclophosphamide Induced Taste Deficits (Nabanita Mukherjee)	Eugene Delay
	Shane Celis	32B	Measuring Transferability in Simulated Robotics	Joshua Bongard
	Somdeb Chatterjee	33B	CROWDSOURCING PREDICTORS FOR MODELING BEHAVIORAL OUTCOMES	Joshua Bongard
	Nick Cheney	67B	Automating Lifetime Body Change in Simulated Robots	Joshua Bongard
	James Christenson	56B	Examination of Metamorphic Assemblages in the Tavan Har Basement Block, Mongolia	Laura Webb
	Eric Clark	4B	Prosocial Behavior on Twitter (Suma Desu)	Christopher Danforth
	Gordon Clark	51B	Identifying the Magnitude and Spatial Extent of Water Drainage Impairments in the Winooski	Beverley Wemple
	Sarah Clark	85B	The interaction of prototoxins with nicotinic acetylcholine receptors	Felix Eckenstein
	Kelsey Cook	91B	An Inquiry into the Boundaries Between Species and their Hybrids: The Case of Polypodium	David Barrington
	Kathryn Daly	55B	The potential for developing a 500 year tree-ring time series for Moosehead Lake, Maine using	Shelly Rayback
	Tiyasha De Pinto	60B	Integrating Sustainability with Transport Asset Management Processes: Governance of	Asim Zia
	Payal Desai	53B	Child vs Parent Perception of HRQOL in Healthy Weight and Obese Children (Hannah Wilder)	Connie Tompkins
	Meagan DiVito	36B	Evaluating the Physical Activity Levels of Head Start Children Using the CATCH Curriculum	Jean Berino
	Kelly Dolan	25B	Community Gardens in the Burlington Area: Emphasizing inclusion and collaboration	David Conner
	Erin Donovan	38B	Use of the Response to Instruction Framework for Mathematics	Katharine Shepherd
	Peter Doubleday	13B	Comparative Phosphoproteomic Analysis of Neonatal and Adult Murine Brain	Bryan Ballif
	Nicholas Dove	48B	The influence of different forest management treatments on fungal diversity	William Keeton
	Simonne Eisenhardt	2B	Effectiveness of an Online, Interactive Energy Balance Curriculum for Young Adults	Stephen Pintauro
	Tyler Feralio	21B	Development of an Exhaust Dilution System for Real-World Particle Number Emissions	Britt Holmen
	Erin Flynn	61B	Media Discourse Analysis of Sugar Sweetened Beverage Taxes (Benjamin Carlson)	Richard Watts
	Morgan Frank	65B	Movement and Happiness in the Twittersphere	Christopher Danforth
	Jonathan Godbout	66B	Maximal Crossing Numbers for Graphs Embedded on the Circle	Dan Archdeacon
	Jonathan Gonzalez	90B	The influence of ungulate grazing history and soil biota on plant tolerance to simulated herbivory	Alison Brody
	Samuel Gorton	82B	Ecological Design and Evaluation for Integrated Food-Energy Systems	Mary Watzin
	Kelly Halloran	50B	Estimation of population size and density of Thornicroft's giraffe (Giraffa camelopardalis thornicrofti)	James Murdoch
	Cynthia Harris	57B	A Night to Remember: Gender and Sexuality at the High School Prom	Melanie Gustafson
	Dylan Harry	43B	An investigation of Northeastern forest health over the past 26 years	Jennifer Pontius
	Kathleen Hartin	52B	Eyo matamanai alakuwa: the social implications of conservation-induced displacement for the	Pablo Bose
	Yainna Hernáiz-Hernández	16B	Determining abundance and diversity of fungi in the Harvester Ants (Genus: Pogonomyrmex)	Sara Cahan
	Michael Herrmann	17B	Queens in Control: Males do not show adaptive mating behavior in hybridizing harvester ants	Sara Cahan
	Kristi Herzer	19B	The Stress and Antibiotic Response of Clinical Isolate Pseudomonas aeruginosa (Jaime Jiménez-Díaz)	Jane Hill
	Anna Hilton	3B	Cuban Revolutionary Healthcare	Benjamin Eastman
	Ilknur Icke	34B	Active Learning Based fMRI Study Design	Joshua Bongard
	Kiara Irick	95B	The relative contribution of Peer Versus Parent Attachment in Emerging Adulthood	Jamie Abaied
	Catherine Jenkins	45B	An investigation into the effect of climate on the $\delta^{13}C$ ratios in an Eastern (Emily Aldrich)	Shelly Rayback
	Daniel Jenkins	58B	Common Respiratory Illnesses of MEDLIFE patients in Lima, Peru	William Falls
	Kirk Jones	22B	Correlating Geomorphic and Habitat Assessments with Water Quality Parameters in Vermont Streams	Donna Rizzo

Student	Location	Title	Advisor
Stacy Jorgensen	92B	Insights into the relationships of three Costa Rican allotetraploids in the fern genus Polystichum	David Barrington
John Kasumba	41B	Chemical characterization of primary and secondary biodiesel exhaust particulate matter	Britt Holmen
Alison Kelly	40B	Burlington City Arts at its 30th Anniversary: Understanding and Celebrating their Story	Patrick Neal
Michael Klug	69B	Factor XI Activation	Stephen Everse
Chelsea Krisanda	96B	Parent Depressive Symptoms in Combination With Secondary Family (Justin Parent, Annie Wright)	Rex Forehand
Nicole Lafko	94B	Proactive and Reaction Functions of Relational Aggression Relating to Internalizing Symptoms:	Dianna Close
Michele Langone	100B	Multifunctional gardens to bring beauty and sustainability to UVM's campus	Mark Starrett
Emily Larson	20B	On the Move: Characterizing Trafficking Genes Whose Expression is Altered in the Cell Wall Mutant	Mary Tierney
Lindsay Lawes	63B	Evaluating the Impact of a Living with Diabetes Self-Management Class	Amy Nickerson
Pamela Lescault	76B	Genome-wide patient-specific expression profiles captured from disseminated neuroblastoma cells	Jeffrey Bond
Paul Lessard	68B	Topological Model for Cultural Variation in Economic Behaviour	Peter Dodds
Katherine Leugers	59B	Incorporation of a Skills-Based PA Curriculum in a High School Health Class	Connie Tompkins
Cherie Lum	99B	Exploring Chinese American Identity in a Predominately White University: A Qualitative Approach	Cynthia Reyes
Geoffrey May	23B	Vibration Monitoring and Load Characteristics Evaluation of I-89 Bridge 58N	Eric Hernandez
Ellen Montgomery	37B	The Experiences of Immigrant and Refugee Students in a Visual Arts Classroom in an Urban Middle	Cynthia Reyes
Benjamin Moody	86B	The Effects of MeHg on the Developing Drosophila Nervous System	Matthew Rand
Elysia Nelson	81B	A Social Capital Basis for Environmental Concern: Evidence from Northern New England	Thomas Macias
Amanda Northrop	101B	Use of lithium heteropolytungstate heavy liquid in condont microfossil recovery for biostratigraphy	Charlotte Mehrtens
Iwan Nyotowidjojo	73B	Tachycardia-induced Incomplete Relaxation And Left Ventricular Volume Loss In Concentric	Markus Meyer
Samantha Ogilvie	75B	Analysis of in vitro mRNA processing provides insight into the integration of mRNA splicing	Gregory Gilmartin
Walten Owens	70B	PTDL, Diagnostic Capabilities and Instrumentation	Douglas Fletcher
Mital Pandya	1B	Molecular characterization of bovine major histocompatibility complex (MHC) class I & II genes	John Barlow
Matthew Pescatore	26B	Multifunctional Agriculture in the Northeast: Motivations and Impacts of Diversified Farm Activities	Chyi-Lyi Liang
Peter Pettengill	83B	Traveler Perspectives of Greenway Quality in Northern New England	Robert Manning
Kyriel Pineault	11B	Cell Surface Events Modulating factor V Endocytosis by Megakaryocytes: A Possible Role for Receptor	Gregory Gilmartin
Joshua Pothen	9B	An Agent-Based Model Of Allergic Airway Inflammation	Jason Bates
Kelsey Preston	77B	Is FoxM1 the Therapeutic Target of Thioestrepton in Malignant Mesothelioma?	Nicholas Heintz
Miranda Redmond	93B	Identification and Characterization of a Novel Cooperative Activity between the Proto-oncogenic	Bryan Ballif
Morgan Rivers	64B	Examination of racial and regional differences in total energy intake and percent fat following a	Amy Nickerson
Amy Rumora	8B	Physical and functional characterization of distinct single-stranded DNA-binding subdomains in	Robert Kelm
Emily Russell-Roy	84B	Rehabilitation forestry and carbon market access on overharvested, former industrial northern	Jennifer Pontius
Bridget Sarpong	72B	Intermittent Preventive Treatment for Controlling Malaria in Infants and Children in Ghana	Burton Jr.
Olivia Saucier	28B	A social history of organic dairy production in the United States	Robert Parsons
Patrick Scheld	27B	Giving a Voice to those often Unheard: An Impact Assessment of International Service-Learning on	Joshua Farley
Rachel Schneider	98B	Positive Youth Development in Vermont's Youth	Holly Busier
Emily Smith	88B	Dynamic Analysis of Radio Pulsar B1237+25's Emission and Polarization Modes	Joanna Rankin
Phoebe Spencer	29B	Bicycle Commuting in Vermont: Environmental, Social, and Physical Challenges in a Northern Climate	Richard Watts
Cameron Stern	79B	Improving Hemerocallis (Daylily) breeding techniques using Diploid and Tetraploid Conversions	Mark Starrett
Chan Stevens	44B	Resistance Modeling in Bolivian Triatomine Bugs: An Evaluation of Methods	Lori Stevens
Christopher Tardie	39B	Determining Water Content in Snow-packs through Gamma Radiation Measurements	Jeff Frolik
Genesis Tejada	15B	"Biodiversity and Infectious Disease Risk: Genetic Variability of Myxobolus cerebralis"	Lori Stevens
Alexander Temple	7B	Hypoxia Effects on MKP-1 Production	Karen Lounsbury
Jacob Wahlen-Strothman	89B	Magneto-optical spectroscopic studies of solid and solution-phase tetra-phenyl porphyrin	Kelvin Chu
Genna Waldvogel	47B	Riparian plant senescence and the effects on stream nutrients and benthic biology in Alaskan Arctic	William Bowden
Marion Weir	14B	Identification and Characterization of a Novel, Isoform-Specific Phosphorylation Site of Collapsin	Bryan Ballif
Samantha Westbrook	10B	Examining the effects of limiting web size on mass accumulation in Nephila clavipes.	Linden Higgins
Dylan White	74B	The effects of the Pseudomonas aeruginosa quorum-sensing molecule 3-oxo-C12-homoserine	Douglas Johnson
Hannah Wilder	54B	Obese 3rd-5th graders Report Significantly Lower Levels of Physical Act (Payal Desai, Dylan Bellavance)	Connie Tompkins
Meghan Winget	24B	The Use of Comic Strip Conversations to Remediate Behavior Regulation Difficulties in a Child	Tiffany Hutchins
Anna Wright	97B	Effects of Gender Differences on Parental Tolerance of Child (Justin Parent, Chelsea Krisanda)	Rex Forehand

Event Schedule

Check-in for All Presenters will be from 7:30am until 4:00pm

8:00am - 9:00am	Poster Set-Up (Morning Session)
8:00am - 12:00pm	Oral Presentations
9:00am - Noon	Poster Presentations
12:00pm - 1:00pm	Poster Set-Up (Afternoon Session)
12:30pm - 4:30pm	Oral Presentations
1:00pm - 4:00pm	Poster Presentations

Light refreshments will be served all day.

Thank You to Our Underwriters

Center for Teaching and Learning
College of Agriculture and Life Sciences
College of Arts and Sciences
College of Education and Social Services
College of Engineering and Mathematical Sciences
College of Medicine
College of Nursing and Health Sciences
Community-University Partnerships & Service Learning
Dudley H. Davis Center
Graduate Student Senate
James M. Jeffords Center

McNair Scholars Program
NEAGEP Program
Office of Undergraduate Research
UVM's Print & Mail Center
Rubenstein School of Environment and Natural Resources
School of Business Administration
Student Government Association
Transportation Research Center
UVM Libraries
Vermont Advanced Computing Core
Vermont Complex Systems Center
Vermont EPSCoR